



ALPS Manufacturer of Electronic Components/Parts Catalog

## Motor-driven Master Type (Motor N Fader, Motor K Fader)

## Detail

Part number		RSA0N11M9A0K
Number of resistor elements		Single-unit
Direction of lever		Vertical
Travel		100mm
Type		Motor N fader
Lever type		9-T (T-Bar)
Length of lever		8.2mm
Total resistance		10kΩ
Resistance taper		1B
Terminal style		Lead
Touch sense track		With
Minimum order unit (pcs.)		200
Operating temperature range		-10°C to +60°C
Electrical performance	Total resistance tolerance	±20%
	Maximum operating voltage	500V AC, 10V DC
	Rated voltage of motor	10V DC
	Maximum current of motor	800mA or less (at 10V DC)
Mechanical performance	Operating force	0.3 to 1.3N
	Stopper strength	100N
	Lever push-pull strength	50N
	Lever wobble (Both side)	2(2×L)/25mm
	Lever deviation (One side)	0.5mm max.
Solder heat resistance	Manual soldering	350°C max. 3s max.
Durability	Operating life	30,000 cycles
	Cold	-30±2°C for 96h

Environmental performance	Dry heat	70±2°C for 240h
	Damp heat	40±2°C, 90 to 95%RH for 96h
3D CAD (STEP)		
Certificate of Compliance to RoHS regulations		

### ● Dimensions

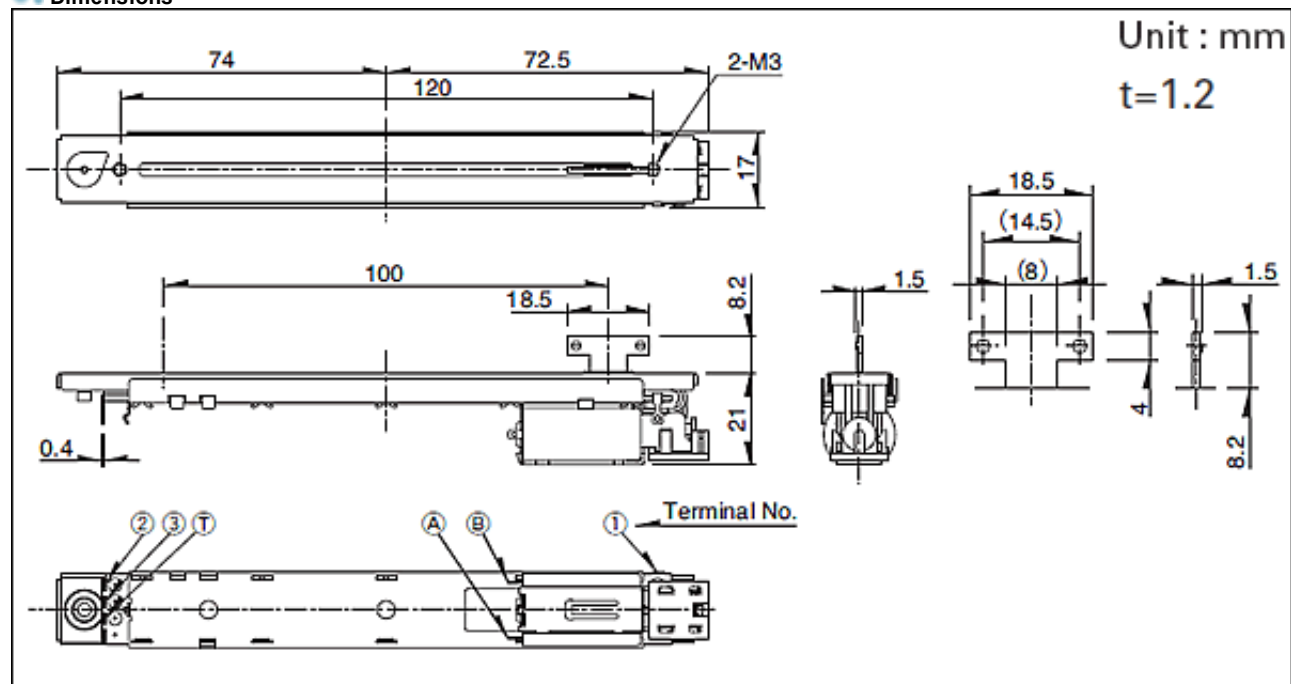

### ● Circuit Diagram

## Motor

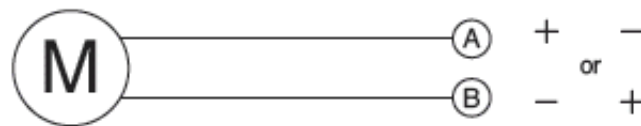

Moving direction of lever and contacts

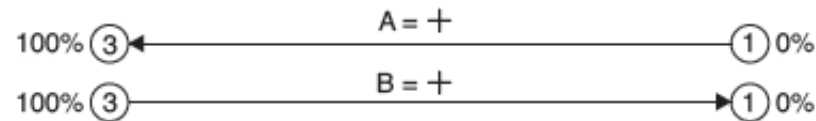

## Servo track

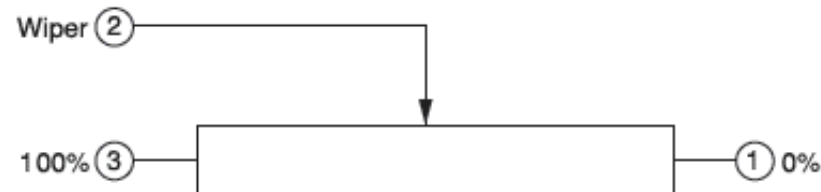

## Touch sense track

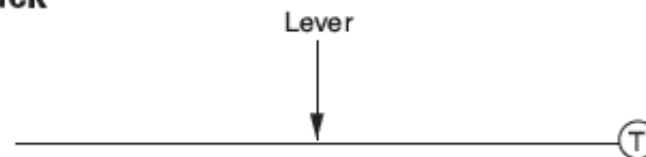

### Packing Specifications

Tray

Number of packages (pcs.)	1 case / Japan	100
	1 case / export packing	200
Export package measurements (mm)		455×578×175

#### NOTE

Notes are common to this series/models.

1. This site catalog shows only outline specifications. When using the products, please obtain formal specifications for supply.
2. Please place purchase orders per minimum order unit (integer).

3. Products other than those listed in above products are also available. Please contact us for details.
4. "L" in the "Lever Wobble" column of the above table indicates the length of lever.



Inquiries about Products

For more information please contact: Products Information Center.

1-7, Yukigaya-otsukamachi, Ota-ku, Tokyo, 145-8501, Japan

Phone: +81 (3) 5499-8154

COPYRIGHT(C) 1995-2012 ALPS ELECTRIC CO., LTD.