

FCI CONFIDENTIAL

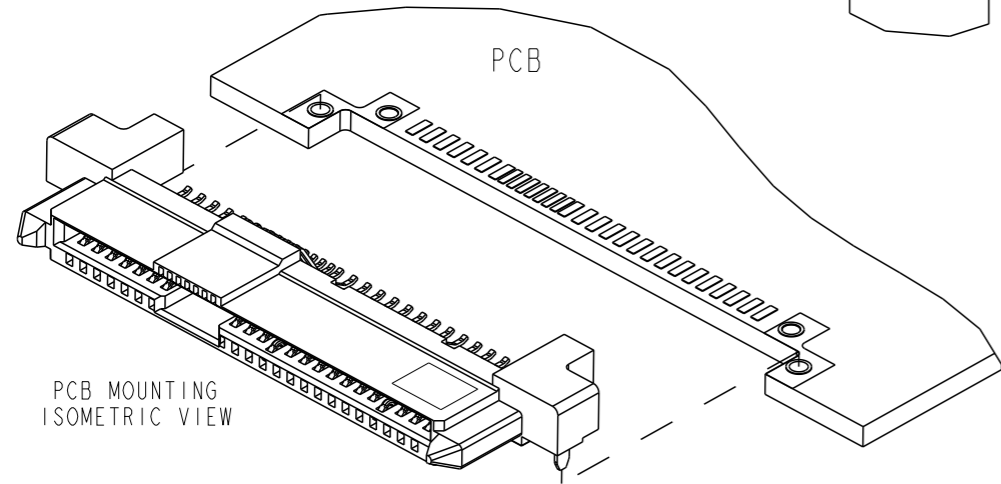

This document is the property of and embodies CONFIDENTIAL and PROPRIETARY information of FCI. No part of the information shown on this document may be used in any way or disclosed to others without the written consent of FCI. Copyright FCI.

PRODUCT NO.	PACKAGING
10036587-001LF	TRAY
10036587-001TRLF	TAPE & REEL
10036587-002LF	TRAY
10036587-002TRLF	TAPE & REEL
10036587-003LF	TRAY
10036587-003TRLF	TAPE & REEL

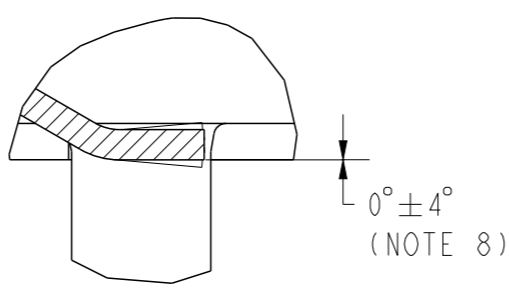

- NOTES:-
- MATERIAL:
    - HOUSING : HIGH TEMP. THERMOPLASTIC, 94V-0, COLOR: BLACK
    - TERMINAL : COPPER ALLOY
    - HOLD DOWN: COPPER ALLOY
  - FINISH:
    - TERMINAL : 30u" Au PLATING (CONTACT POINT) OVER 50u" MIN NICKEL
    - SOLDER TAIL: 100u" MIN TIN OVER 50u" MIN NICKEL
    - HOLD DOWN : 100u" MIN TIN OVER 50u" MIN NICKEL
  - PACKAGING:
    - 10036587-XXXLF : REFER TO STANDARD PACKAGING IN TRAY
    - 10036587-XXXTRLF: REFER TO TAPE AND REEL PACKAGING
  - THE HOUSING WILL WITHSTAND EXPOSURE TO 260 DEGREES CELSIUS PEAK TEMPERATURE FOR 10 SECONDS IN A CONVECTION, INFRE-RED OR VAPOUR PHASE REFLOW OVEN
  - THIS PRODUCT MEETS EUROPEAN UNION DIRECTIVES AND OTHER COUNTRY REGULATIONS AS DESCRIBED IN GS-22-008
  - PART NUMBERS ENDING IN 'LF' MEANS FOR NOTE 5 LEAD FREE IDENTIFICATION, P/N XXXXXXXX-XXXLF IS EQUIVALENT TO PREVIOUS P/N XXXXXXXX-XXX
  - ALL SOLDER TAIL TO BE WITHIN 0.10mm, MAX COPLANARITY.
  - ALL SOLDER TAILS ANGLE CONTROL SHALL BE 0° ± 4° AND APPLIED TO P/n 10036587-XXXLF.
  - A SYMBOL BE NEXT TO ANY DIMENSION, VIEW, OR NOTE WHICH HAS BEEN MODIFIED WITH THE CURRENT DRAWING REVISION.

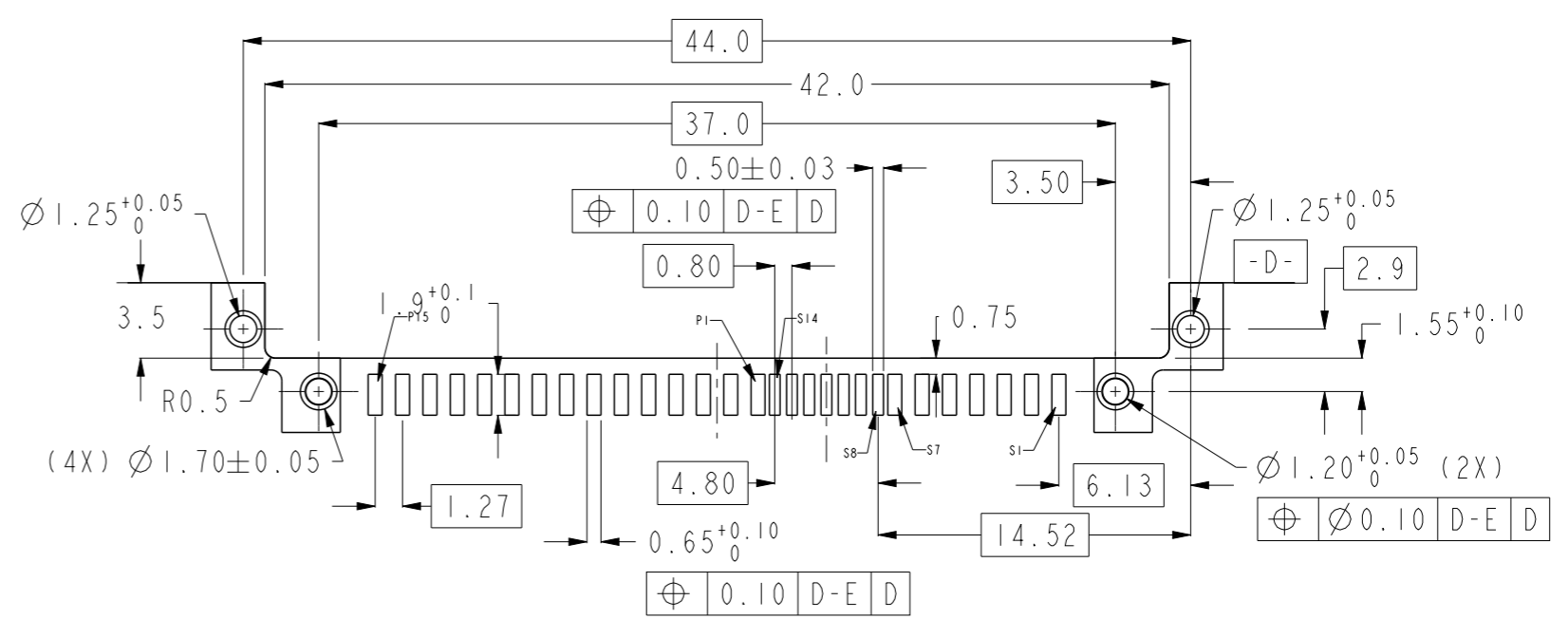

RECOMMENDED PCB LAYOUT  
RECOMMENDED PCB T: 1.6mm  
TOLERANCE UNLESS OTHERWISE: ±0.1

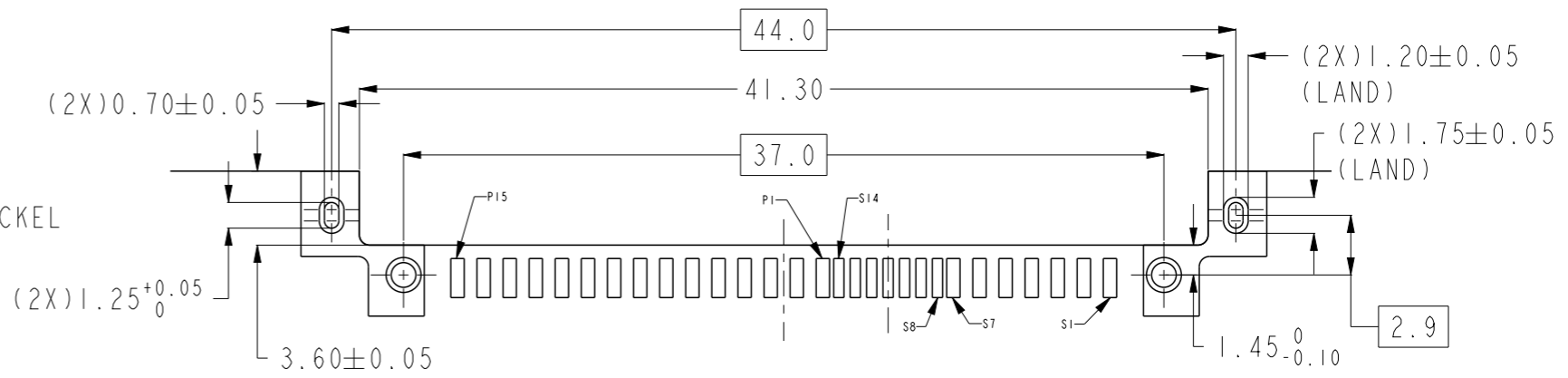

ALTERNATIVE PCB LAYOUT  
REFER TO ABOVE RECOMMENDED PCB LAYOUT FOR UNSPECIFIED DIMENSIONS  
RECOMMENDED PCB T: 1.6mm  
TOLERANCE UNLESS OTHERWISE: ±0.1

TOLERANCES UNLESS OTHERWISE SPECIFIED			tolerance std	material	dr	wcadmin	2006/03/08	projection	MM	size	A3	scale	1:1
linear	X.	±	ASME Y14.5	mat code	eng	Koon-Poh Tay	2011/08/22		← →	ecn no	ELX-S-004960-1		
	0.X	±0.25		heattreat	chr	-	-				rel level	Released	
	0.XX	±0.2		surface	plating/finish	appr	Joey Ng	2011/08/26	product family	-		dwg no	10036587
	0.XXX	±			spec ref	FCI		SAS RECEPTACLE			rev		L
0.XXXX	±	ASME Y14.5	model name	10036587-PCBA-ALT		www.fci.com	cat. no.	-	Product - Customer Drw	sheet 1 of 3			
angular	0°		±0.2°	model revision	B		PDS: Rev :L	STATUS:Released		Printed: Aug 26, 2011			

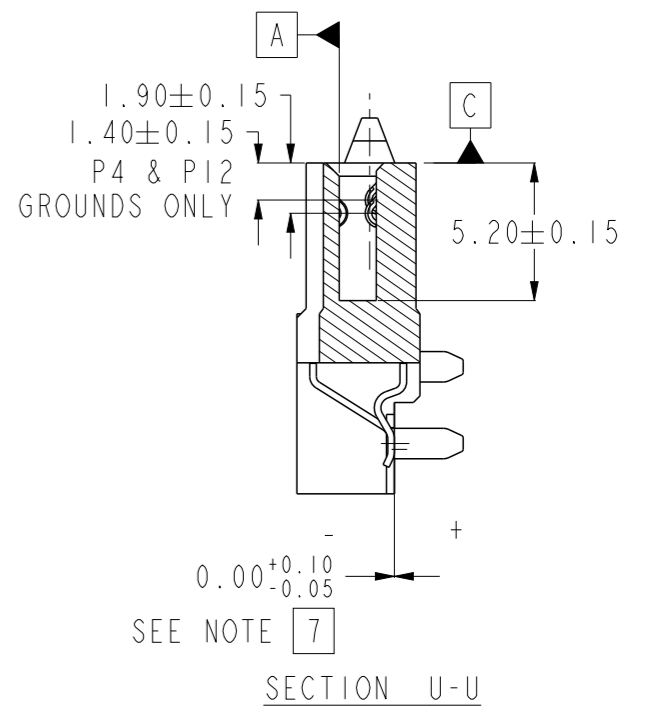
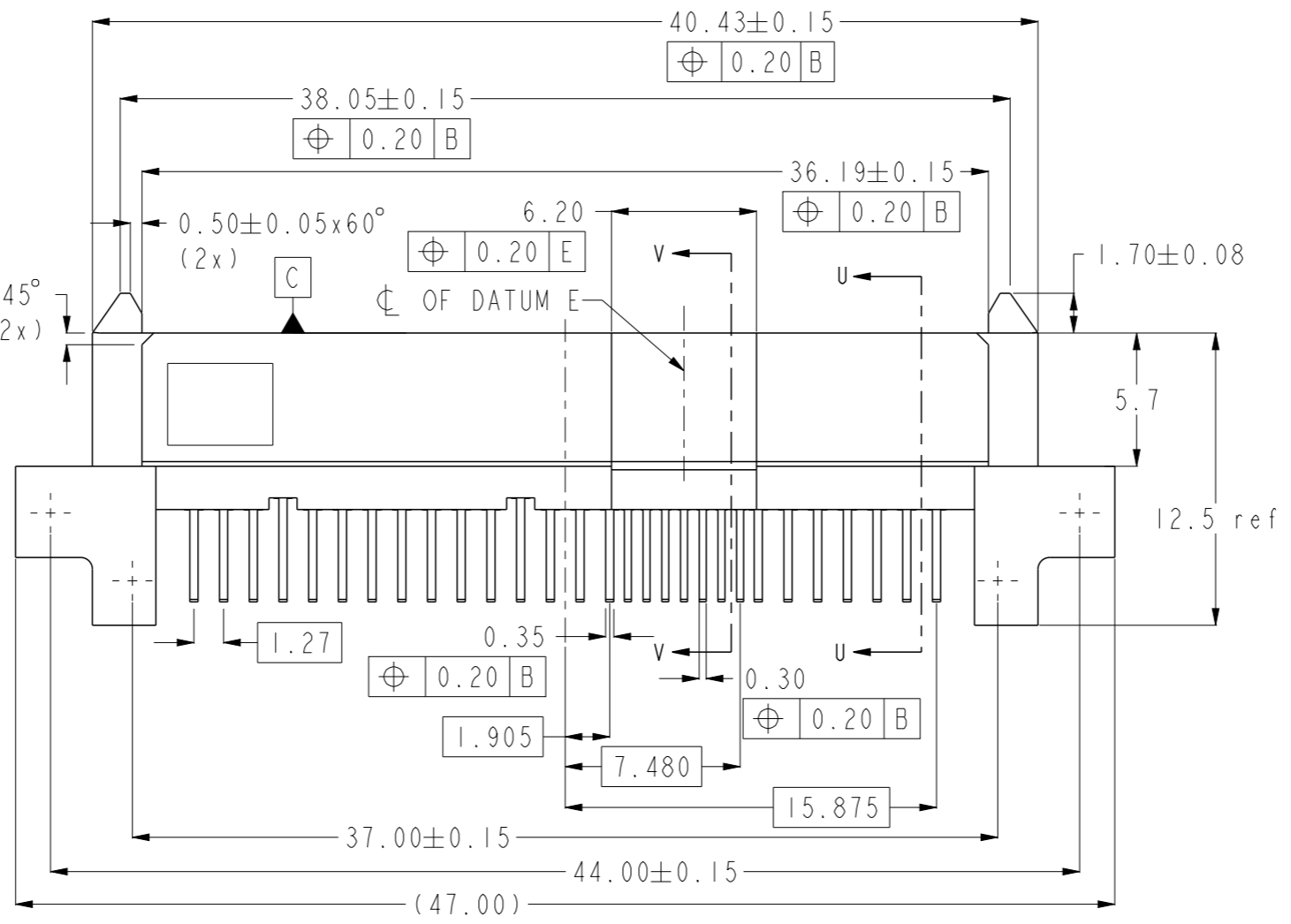
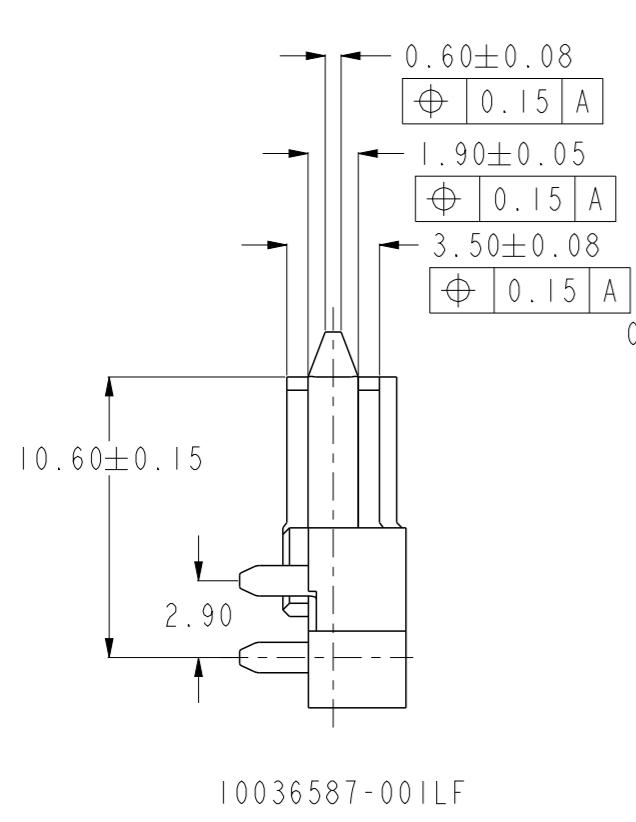
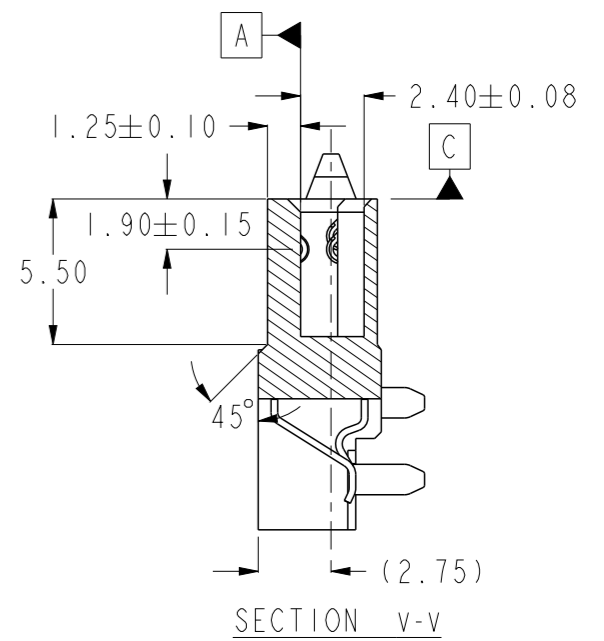
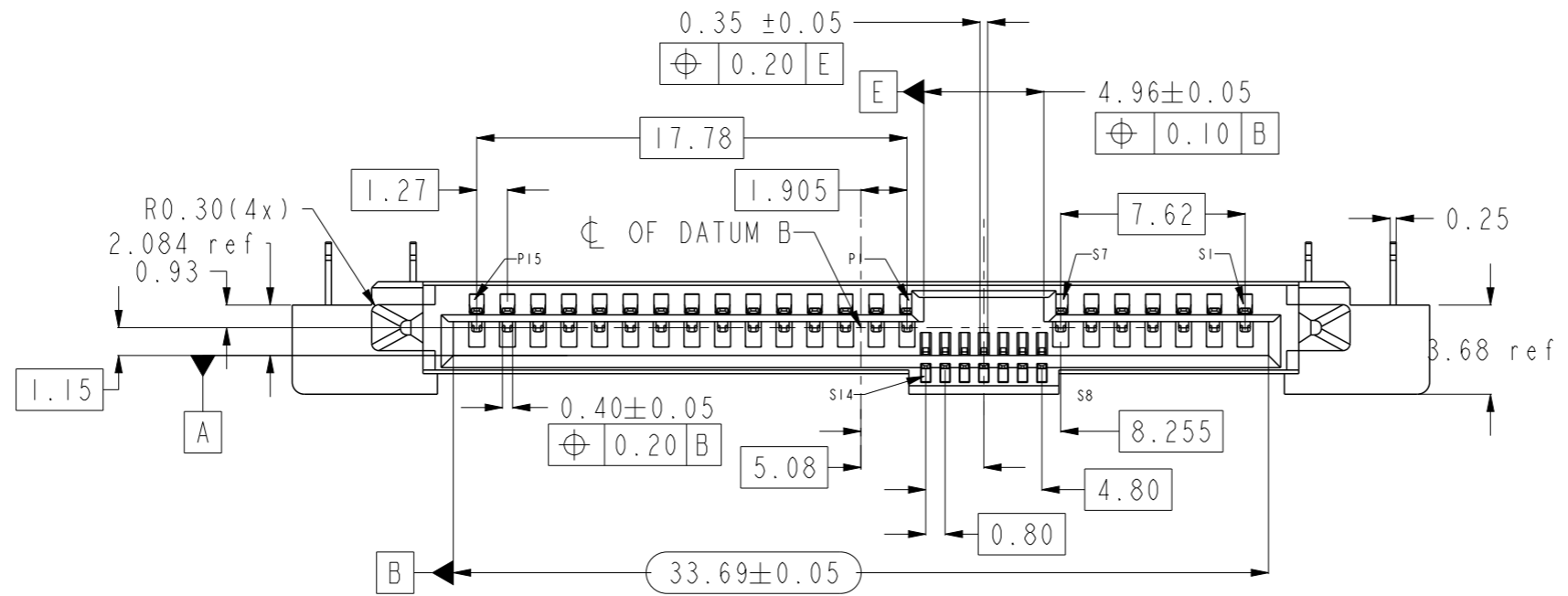

tolerance std	material	-	dr	wcadmin	2006/03/08	projection	MM	size	A3	scale	1:1	
	mat code	-	eng	Koon-Poh Tay	2011/08/22			ecn no	ELX-S-004960-1			
	ASME Y14.5	heat treat	-	chr	-			product family	-	rel level	Released	
surface	plating/finish	-	appr	Joey Ng	2011/08/26	SAS RECEPTACLE R/A SMT ASSY	dwg no	10036587	rev	L		
	spec ref		www.fci.com	cat. no.	-						Product - Customer Drw	sheet 2 of 3
	ASME Y14.5	model name	10036587-PCBA-ALT									
	model revision	B										

FCI CONFIDENTIAL



This document is the property of and embodies CONFIDENTIAL and PROPRIETARY information of FCI. No part of the information shown on this document may be used in any way or disclosed to others without the written consent of FCI. Copyright FCI.

10036587-001LF

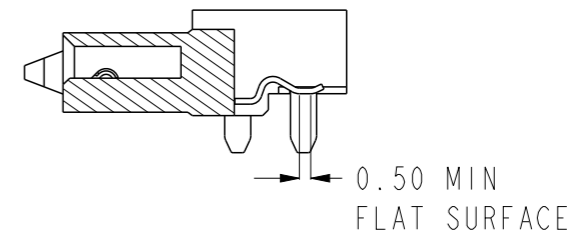
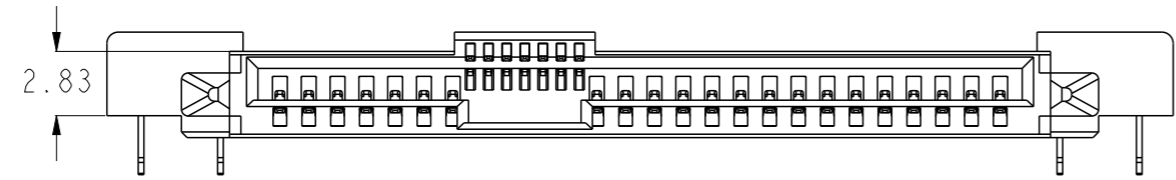

10036587-002LF

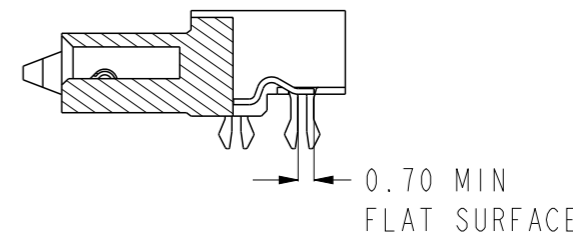
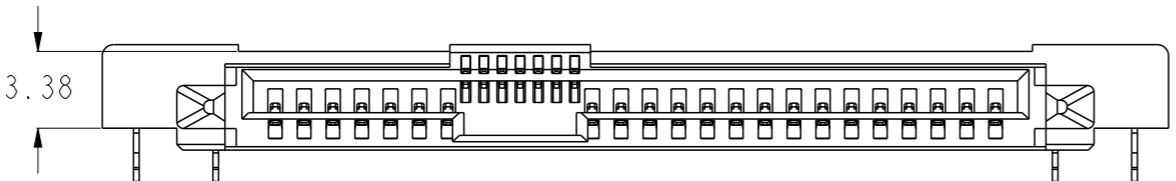

10036587-003LF

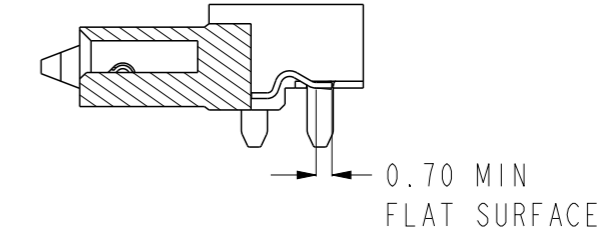
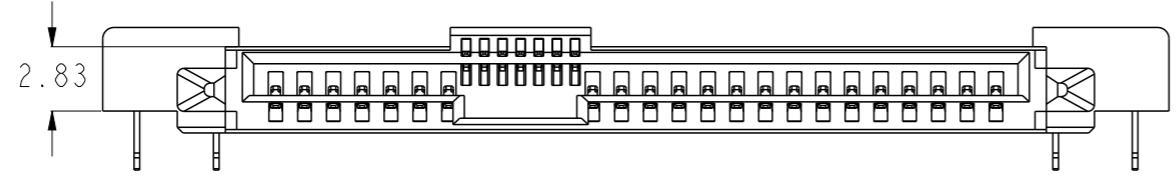

UNSPECIFIED DIMENSIONS PLEASE REFER TO PAGE 1 & 2

tolerance std	material	-	dr	wcadmin	2006/03/08	projection	MM	size	A3	scale	1:1		
	mat code	-	eng	Koon-Poh Tay	2011/08/22			ecn no	ELX-S-004960-1				
	ASME Y14.5	heat treat	-	chr	-	product family	-	rel level	Released				
surface	spec ref		appr	Joey Ng	2011/08/26	title		SAS RECEPTACLE		dwg no	10036587	rev	L
	ASME Y14.5	model name	10036587-PCBA-ALT	www.fci.com		cat. no.		-	Product - Customer Drw		sheet 3 of 3		
		model revision	B										