

Multiple Turn Axial Wire Ferrite Beads / Cores



- Differential Mode EMI Filters
- Lead free & RoHS Compliant
- Thru-Hole Application
- Wire Wound Thru Ferrite
- Low DCR

PART NUMBER SYSTEM EXAMPLE

28	C	0236	-0	B	S	-10
Material Type	Product Code	Part Size Code	Selected Dimension Code	Additional Description	Packaging Code	Additional Description

Part Number	TYPICAL IMPEDANCE (Ω)				Typical Peak Impedance (Ω)	Typical Peak Impedance Frequency (MHz)	DCR MAX (Ω)	Rated I Max (continuous) mA
	Z @ 25 MHz	Z @ 100 MHz	Z @ 500 MHz	Z @ 1 GHz				
28C0236-0BS-10	500	835	480	220	846	156	0.01	5,000
28C0236-0BW-10	500	835	480	220	846	156	0.01	5,000
28C0236-0DW-10	260	460	478	360	498	300	0.01	5,000
28C0236-0EW-10	620	998	484	205	1010	140	0.01	5,000
28C0236-0JW-10	620	998	484	205	1010	140	0.01	5,000

Part Number	Fig #	A mm (inches)	B mm (inches)	C mm (inches)	D mm (inches)	E mm (inches)	F mm (inches)	L1 mm (inches)
28C0236-0BS-10	1	6.00 (0.236)	14.99 (0.590)	10.00 (0.394)	0.51 (0.020)	14.61 (0.575)	-	5.99 (0.236)
28C0236-0BW-10	2	6.00 (0.236)	86.46 (3.404)	10.00 (0.394)	0.51 (0.020)	14.61 (0.575)	-	38.10 (1.500)
28C0236-0DW-10	3	6.00 (0.236)	86.46 (3.404)	10.00 (0.394)	0.51 (0.020)	14.61 (0.575)	-	38.23 (1.505)
28C0236-0EW-10	4	6.00 (0.236)	50.53 (1.989)	10.00 (0.394)	0.51 (0.020)	14.61 (0.575)	-	38.10 (1.500)
28C0236-0JW-10	5	6.00 (0.236)	20.96 (0.825)	10.00 (0.394)	0.51 (0.020)	15.90 (0.626)	5.08 (0.200)	5.08 (0.200)

See diagram 1 on page 48 for equivalent circuit

Figure #1

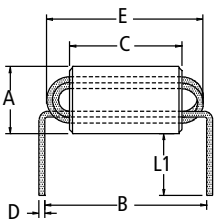

Figure #2

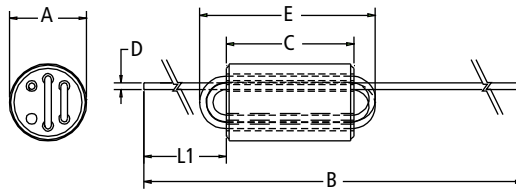

Figure #3

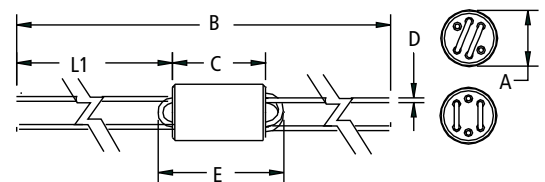

Figure #4

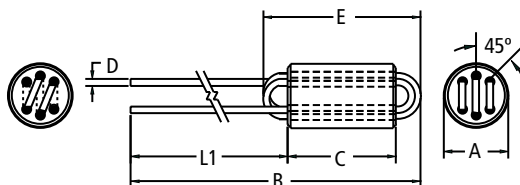

Figure #5

