

- NOTES:
- FINISH:
 - 1-1 TERMINAL :
 - 50~200μ NICKEL UNDER PLATED
 - 15μ GOLD PLATING ON CONTACT AREA
 - 3μ MIN GOLD FLASH ON SOLDERING AREA
 - 1-2 SHELL :
 - 50~200μ NICKEL UNDER PLATED
 - 3μ MIN GOLD FLASH ON SOLDERING AREA
 - 1-3 DETECT PIN :
 - 50~200μ NICKEL UNDER PLATED
 - 3μ MIN GOLD PLATING ON CONTACT AREA
 - 3μ MIN GOLD PLATING ON SOLDERING AREA
 - SOLDER TAIL COPLANARITY: 0.08MM MAX.
 - TERMINAL TIP MUST SINK INTO HOUSING
 - PRODUCT COMPLIANT TO ROHS DIRECTIVE 2002/95/EC AND ELV DIRECTIVE 2000/53/EC
 - DETECT SWITCH: INSERT CARD=ON (NORMAL=OPEN)
 - SPRING RISE UP DURING PUSH-PUSH PERIOD
 - PACKAGE DRAWING: PK-47553-001
 - PRODUCT SPECIFICATION: PS-47553-201

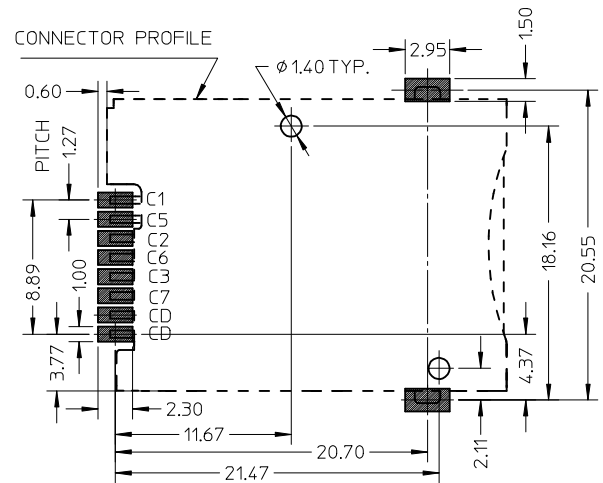
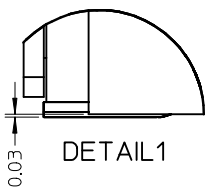
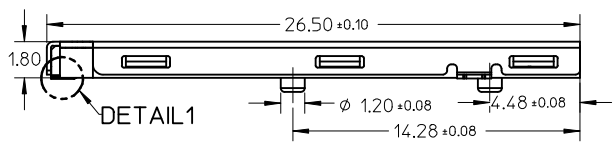
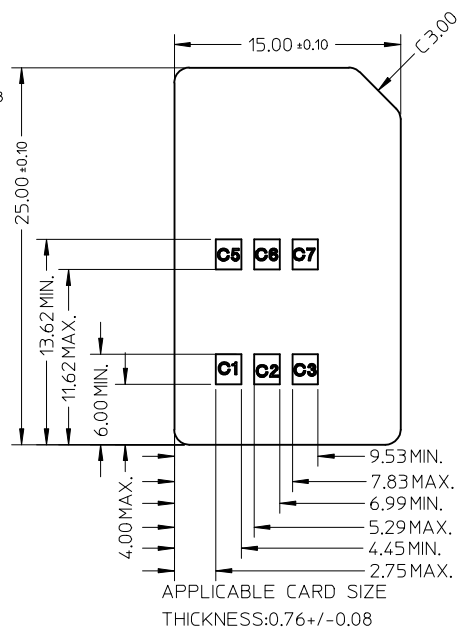
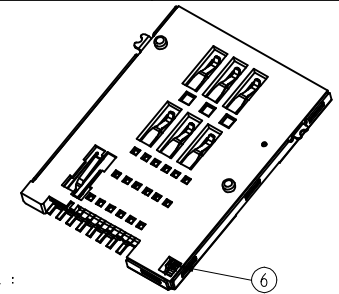

CARD INSERTED		WITHOUT CARD	
NO.	DESCRIPTION	Q'TY	MATERIAL
1	HOUSING	1	HIGH TEMPERATURE THERMOPLASTIC
2	TERMINAL	6	COPPER ALLOY
3	DETECT PIN LOWER	1	COPPER ALLOY
4	DETECT PIN UPPER	1	COPPER ALLOY
5	SHELL	1	STAINLESS STEEL
6	COIL SPRING	1	PIANO WIRE
7	HEART CAM	1	HIGH TEMPERATURE THERMOPLASTIC
8	CAM PIN	1	STAINLESS STEEL

REVISED EC NO: DRWN: YPWU CHKD: YLZHUOZ APPR: REV	DESCRIPTION 2009/03/11	QUALITY SYMBOLS	GENERAL TOLERANCES (UNLESS SPECIFIED)	DIMENSION STYLE	SCALE	DESIGN UNITS	THIRD ANGLE PROJECTION	
		▽=0	mm INCH	MM ONLY	4:1	METRIC		
		∇=0	4 PLACES ± --- ± ---	DRAWN BY	DATE	TITLE	PUSH PUSH 6 PINS SIM WITH DETECT PIN&POST SALES DRAWING	
			3 PLACES ± --- ± ---	LHSHEN	2007/07/09	MOLEX INCORPORATED		
		2 PLACES ± 0.15 ± ---	CHECKED BY	DATE	DOCUMENT NO. SD-47553-201			
		1 PLACE ± --- ± ---	XUXIANG	2007/08/30	SHEET NO. 1 OF 1			
		ANGULAR ± --- °	APPROVED BY	DATE	THIS DRAWING CONTAINS INFORMATION THAT IS PROPRIETARY TO MOLEX INCORPORATED AND SHOULD NOT BE USED WITHOUT WRITTEN PERMISSION			
			HWWANG	2007/08/30				
			MATERIAL NO.					
			475532001					
			DRAFT WHERE APPLICABLE MUST REMAIN WITHIN DIMENSIONS	SIZE				
				A3				

English 日本語 한국어 简体中文

Search: Go

Register | Login
My Parts (0 items)

- Product Name
 - Cross-Ref
 - Catalog
 - Literature
 - Industries
 - Standards
 - Contact Us
 - About Us
 - Investors
 - Careers
-
- Connectors
 - Sockets
 - I/O Connectors
 - Cable Assemblies
 - Fiber Optics
 - Printed Circuit Products
 - Industrial Products
 - Lighting Products

[Home](#) [Memory Card Sockets](#) [Datasheet](#)

Switch Language

English

Need Assistance?

- Contact Us
- Find a Distributor
- Order Samples
- Tech Library
- Ecocare
- Electrical Models

[Printer-friendly page](#)

[Email this page](#)

Part Number: 0475532001

Status: Active **Overview: SIM - Smart Card**

Description: 1.27mm (.050") Pitch SIM Card Holder with 2 Detect Pins, 6 Circuits, Push-Push Style, Housing Height 1.80mm (.071"), with Pegs, Lead Free

- Documents:** [Note - Please disable browser pop-up blockers for documents on www.molex.com](#)
[Drawing \(PDF\)](#) [Product Specification PS-47553-201 \(PDF\)](#)
[3D Model](#) [RoHS Certificate of Compliance \(PDF\)](#)

Order Products:

- [Check Distributor Inventory](#) [Add to My Parts](#) [Request Samples](#)

Part Detail: (show all)

- [General](#) [Physical](#) [Electrical](#) [Solder Process Data](#) [Material Info](#)
[Reference - Drawing Numbers](#)

General

Product Family	Memory Card Sockets
Series	47553
Comments	With Pegs
Component Type	Card Holder (Host)
Overview	SIM - Smart Card
Product Name	SIM
Style	Push-Push
Type	N/A

Physical

Card Detection Switch	Yes
Circuits (Loaded)	6
Circuits (maximum)	6
Durability (mating cycles max)	2, 500
Ejector Button	No
Ejector Button Side	N/A
Entry Angle	Horizontal
Keying to Mating Part	Yes
Material - Metal	Copper Alloy
Material - Plating Mating	Gold
Material - Plating Termination	Gold
Material - Resin	High Temperature Thermoplastic
PCB Locator	Yes
PCB Mounting Side	Normal
PCB Retention	Yes
Packaging Type	Embossed Tape on Reel
Pitch - Mating Interface (in)	0.100 In
Pitch - Mating Interface (mm)	2.54 mm
Pitch - Term. Interface (in)	0.050 In
Pitch - Term. Interface (mm)	1.27 mm
Plating min: Mating (µin)	15
Plating min: Mating (µm)	0.38
Plating min: Termination (µin)	3
Plating min: Termination (µm)	0.076
Ports	1
Temperature Range - Operating	-20°C to +85°C
Termination Interface: Style	Surface Mount

Electrical (Please review the Product Specification for specific details.)

Current - Maximum per Contact	0.5A
Shielded	Yes
Voltage - Maximum	50V DC

Solder Process Data

Duration at Max. Process Temperature (seconds)	3
Lead-free Process Capability	Reflow Capable (SMT only)
Max. Cycles at Max. Process Temperature	2
Process Temperature max. C	250

Material Info

Reference - Drawing Numbers

Packaging Specification	PK-47553-001, RPK-47553-001
Product Specification	PS-47553-201

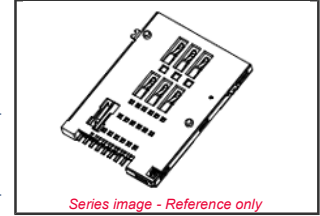

Series image - Reference only

EU RoHS
ELV and RoHS Compliant

China RoHS



REACH SVHC
Not Reviewed

Halogen-Free Status
Not Halogen-Free

Need more information on product environmental compliance?

Email productcompliance@molex.com

For a multiple part number RoHS Certificate of Compliance, [click here](#)

Please visit the [Contact Us](#) section for any non-product compliance questions.

Search Parts in this Series

47553Series

Mates With

Standard SIM Card

Sales Drawing

SD-47553-201

[Feedback](#) [Privacy](#) [Legal](#) [Site Map](#) [Help](#)

Find us on:



Copyright 2005-2010