

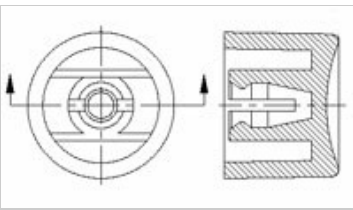

1825068-1 Product Details

[Share](#) [Print](#) [Email](#)



Hardware and Accessories for Mechanical Switches

C22004 CAP BLACK

1825068-1

TE Internal Number: 1825068-1

Active

[View 3D PDF](#)

Product Highlights [View All](#)

- Accessory Type = Pushbutton Switch Boot Seal
- Color = Black
- Used With Switch Type Green Series Push Button Switches
- RoHS compliant, ELV compliant
- Lead Free Solder Processes = Not relevant for lead free process

[Pricing & Availability](#)

[Request Sample](#)

[Add to My Part List](#)

[Buy Product through Distributor](#)

[Documents](#) [Features](#) [Compliance](#)

Product Drawings
CAP, GREEN SERIES, PUSHBUTTON, C22 (PDF, English)
CAD Files ?
2D Drawing (DXF, Version A, ZIP)
3D Model (IGES, Version A, ZIP)
3D Model (STEP, Version A, ZIP)
Product Environmental Compliance
TE Material Declaration
MD_1825068-1_0906201302_dmtec (PDF, English)

Related Products

Not quite the product you're looking for?

[Find Similar Products](#)

[View Part in Product Feature Selector](#)

[Check for Tooling](#)

[Feedback](#)

Corporate Information

- [About TE](#)
- [Investors](#)
- [News Room](#)
- [Supplier Portal](#)
- [Careers](#)
- [Terms & Conditions](#)
- [Privacy Policy](#)
- [Global Accessibility Statement](#)

Quick Links

- [Distributor Inventory](#)
- [Product Cross Reference](#)
- [Documents & Drawings](#)
- [Product Compliance Support Center](#)
- [Site Map](#)

Customer Support

- [Email or Chat With Us](#)
- [Find a Phone Number](#)
- [Knowledge Base](#)
- [Manage Your Account](#)

Keep Me Informed

