

THIS DRAWING IS UNPUBLISHED. RELEASED FOR PUBLICATION
 © COPYRIGHT BY TYCO ELECTRONICS CORPORATION. ALL RIGHTS RESERVED.

LOC	DIST	REVISIONS					
AF	50	P	LTR	DESCRIPTION	DATE	DWN	APVD
			E1	REVISED PER ECR-05-010660	03OCT05	MF	GP

- 1 PRODUCT PROVIDED IN STRIP FORM ON REELS;
BREAKS MAY BE PRESENT.
- 2 WIRE RANGE IS 600-3000 CMA, (SEE NOTE 3).
- 3 CRIMP WIDTH: .110 F TYPE (AMPLIVAR THRU)
CRIMP HEIGHT (± 0.002) = (TOTAL CMA * 9400) / 190,500
GENERAL APPLICATION GUIDELINES MUST BE FOLLOWED AS
SPECIFIED IN CATALOG #82221
FOR APPLICATION INFORMATION CALL: 1-800-722-1111
FOR PRODUCT INFORMATION CALL: 1-800-522-6752
- 4 \triangle 0.002032 [.000080] MIN TIN PLATE.

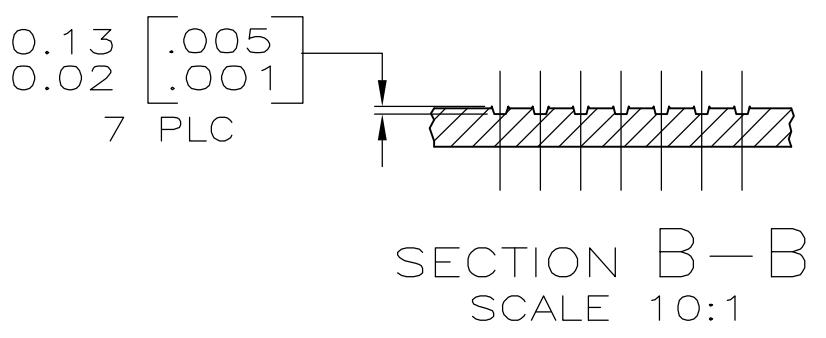
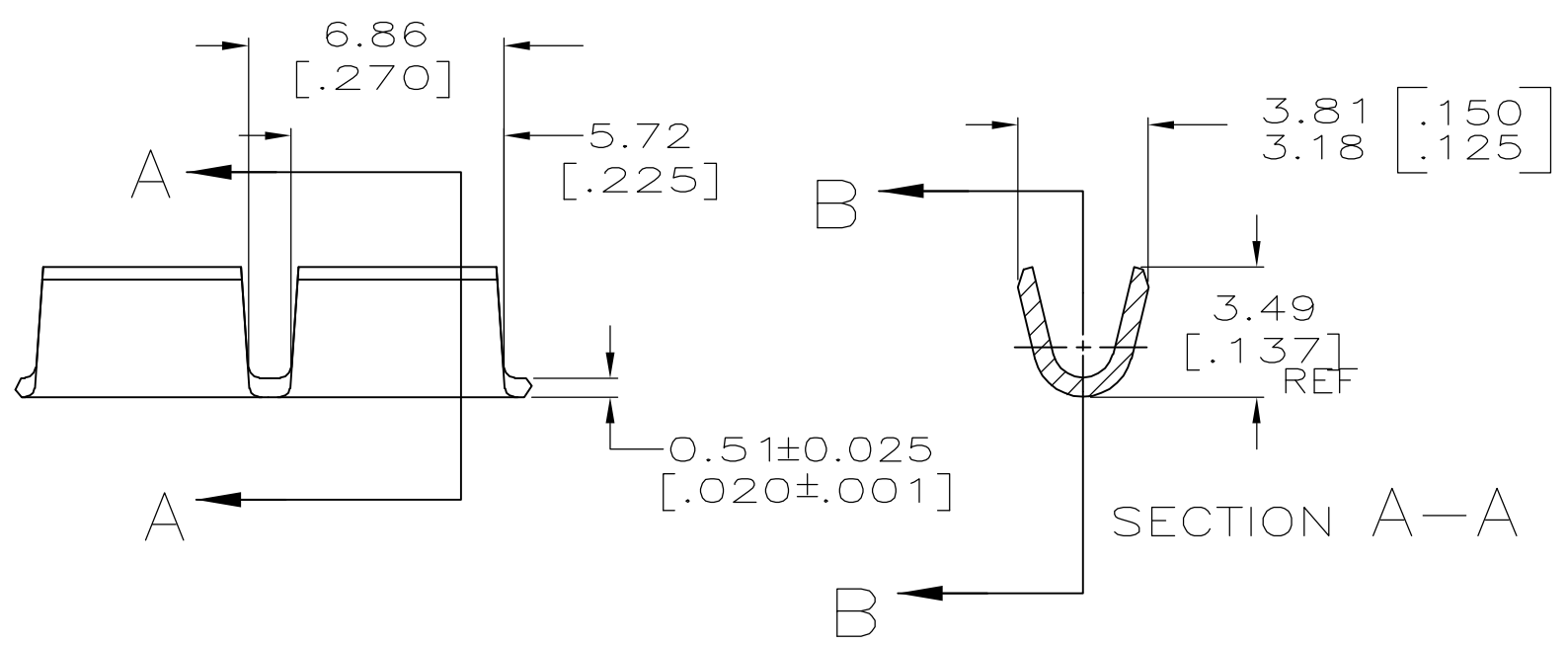
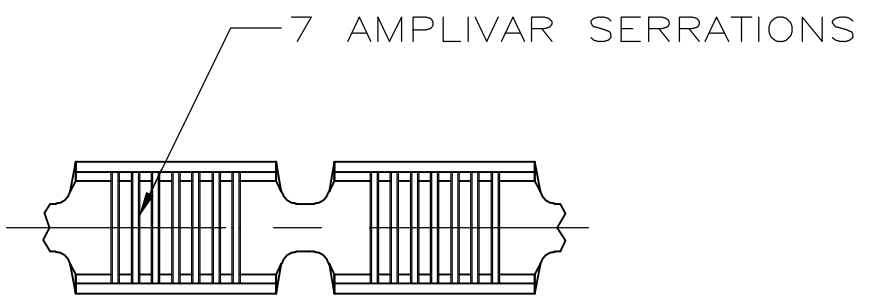

-	1217384-2
\triangle 4	1217384-1
FINISH	PART NUMBER

THIS DRAWING IS A CONTROLLED DOCUMENT.		DWN	JR RUTH	07APR00	 Tyco Electronics Corporation Harrisburg, PA 17105-3608
DIMENSIONS: mm		CHK	MS FEHER	07APR00	
TOLERANCES UNLESS OTHERWISE SPECIFIED:		APVD	G PORTA	07APR00	
0 PLC ± - 1 PLC ± - 2 PLC ± 0.25 [.010] 3 PLC ± - 4 PLC ± - ANGLES ± -		PRODUCT SPEC	-	-	
MATERIAL	082 BRASS	FINISH	SEE TABLE	WEIGHT	-
CUSTOMER DRAWING		SIZE	A3	CAGE CODE	00779
SCALE		DRAWING NO	C=1217384		RESTRICTED TO
SCALE 5:1		SHEET 1 OF 1		REV E1	-