

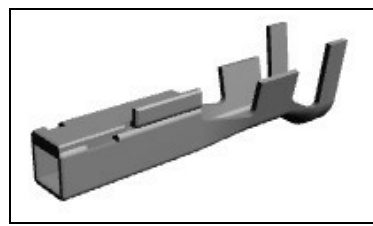

# 1565079-1 Product Details

[Share](#) [Print](#) [Email](#)



**1565079-1**

## 2, 2.5, 3.3, 3.5, 3.96 & 6.2 Centerline 600 V, 12 A max.

Always EU RoHS/ELV Compliant (Statement of Compliance)

### Product Highlights:

- Universal Power Product Line
- Wire-to-Wire
- Applies To Wire/Cable
- Glow Wire Rating = Standard Part - Not Glow Wire
- Contact

[View all Features](#)

### Quick Links

- ▶ Pricing & Availability
- ▶ Search for Tooling
- ▶ View Housings (32)
- ▶ Product Feature Selector
- ▶ Contact Us About This Product

TE Internal Number: 1565079-1

Active

[View 3D PDF](#)

[Add to My Part List](#) [Request Sample](#) [Find Similar Products](#) [Buy Product](#)

## Documentation & Additional Information

**Product Drawings:**

- [GRACE INERTIA CONNECTOR 3.5 REC CONTACT\(L\)](#) (PDF, Japanese)

**Catalog Pages/Data Sheets:**

- [SOFT\\_SHELL\\_PIN\\_AND\\_SOCKET\\_CONNECTORS\\_CATALOG](#) (PDF, English)

**Product Specifications:**

- [GRACE INERTIA CONNECTOR 3.5](#) (PDF, Japanese)

**Application Specifications:**

- None Available

**Instruction Sheets:**

- [Extraction Tool for GIC 3.5 Conn.](#) (PDF, Japanese)

**CAD Files: (CAD Format & Compression Information)**

- [2D Drawing](#) (DXF, Version 0)
- [3D Model](#) (IGES, Version 0)
- [3D Model](#) (STEP, Version 0)

[List all Documents](#)

**Related Products:**

- [Tooling](#)
- [Housings \(32\)](#)

Feedback

## Product Features (Please use the Product Drawing for all design activity)

**Product Type Features:**

- Product Line = Universal Power
- Product Type = Contact
- Wire/Cable Type = Discrete Wire
- Sealed = No

**Mechanical Attachment:**

- Contact Retention = With
- Contact Retention Type = Locking Lance

**Electrical Characteristics:**

- Contact - Rated Current (A) = 2 - 7
- Operating Voltage Reference = AC
- Operating Voltage (VAC) = 300

**Termination Features:**

- Wire/Cable Size (mm<sup>2</sup>) = 0.3 - 0.9
- Wire/Cable Size (AWG) = 18 - 22
- Termination Method to Wire/Cable = Crimp

**Body Features:**

- Wire Type = Stranded

**Contact Features:**

- Contact Type = Socket
- Contact Base Material = Copper Alloy
- Contact Plating, Mating Area, Material = Pre-Tin
- Contact Plating, Mating Area, Thickness (µm [µin]) = 0.8 [31.49]

**Industry Standards:**

- [RoHS/ELV Compliance](#) = RoHS compliant, ELV compliant
- [Lead Free Solder Processes](#) = Not relevant for lead free process
- RoHS/ELV Compliance History = Always was RoHS compliant

**Environmental:**

- Operating Temperature (°C [°F]) = -30 - +105 [-22 - +221]

**Conditions for Usage:**

- Applies To = Wire/Cable
- Glow Wire Rating = Standard Part - Not Glow Wire
- Accepts Wire Insulation Diameter, Range (mm [in]) = 1.50 - 2.70 [0.059 - 0.106]
- For Use With = Plug Housing

**Operation/Application:**

- Application Use = Wire-to-Wire
- Contact Transmits (Typical Application) = Signal (Data)

**Packaging Features:**

- Packaging Method = Reel
- Packaging Quantity = 5,000

**Other:**

- Brand = TE Connectivity
- Comment = Use with Grace Inertia Connector 3.5

## Corporate Information

[About TE](#)  
[Investors](#)  
[News Room](#)  
[Supplier Portal](#)  
[Careers](#)  
[Terms & Conditions](#)  
[Privacy Policy](#)  
[AODA Accessibility Policy](#)  
[AODA Multi-Year Accessibility Plan](#)

## Quick Links

[Distributor Inventory](#)  
[Product Cross Reference](#)  
[Documents & Drawings](#)  
[Product Compliance Support Center](#)  
[Site Map](#)

## Customer Support

[Email or Chat With Us](#)  
[Find a Phone Number](#)  
[Knowledge Base](#)  
[Manage Your Account](#)

## Keep Me Informed

