

THIS DRAWING IS UNPUBLISHED. RELEASED FOR PUBLICATION
 © COPYRIGHT BY TYCO ELECTRONICS CORPORATION. ALL RIGHTS RESERVED.

LOC		DIST		REVISIONS			
P	LTR	DESCRIPTION	DATE	DWN	APVD		
CM	00	A	REVISED PER ECO-08-006965	24MAR08	HMR	CC	

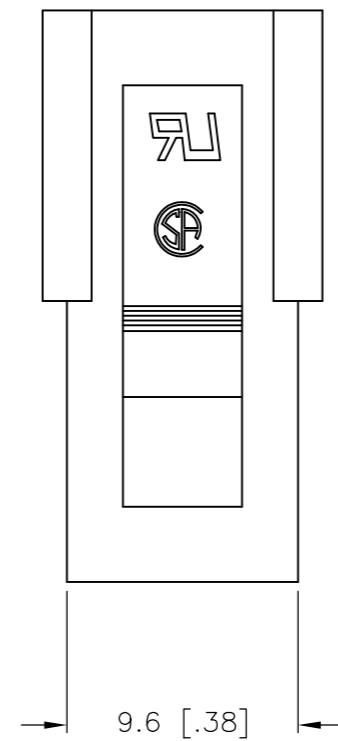

- 1 NYLON, UL94V-V0.
- 2 PANEL MUST BE PUNCHED SO THAT THE HOUSING ENTERS THE PANEL IN THE SAME DIRECTION AS THE PUNCH.

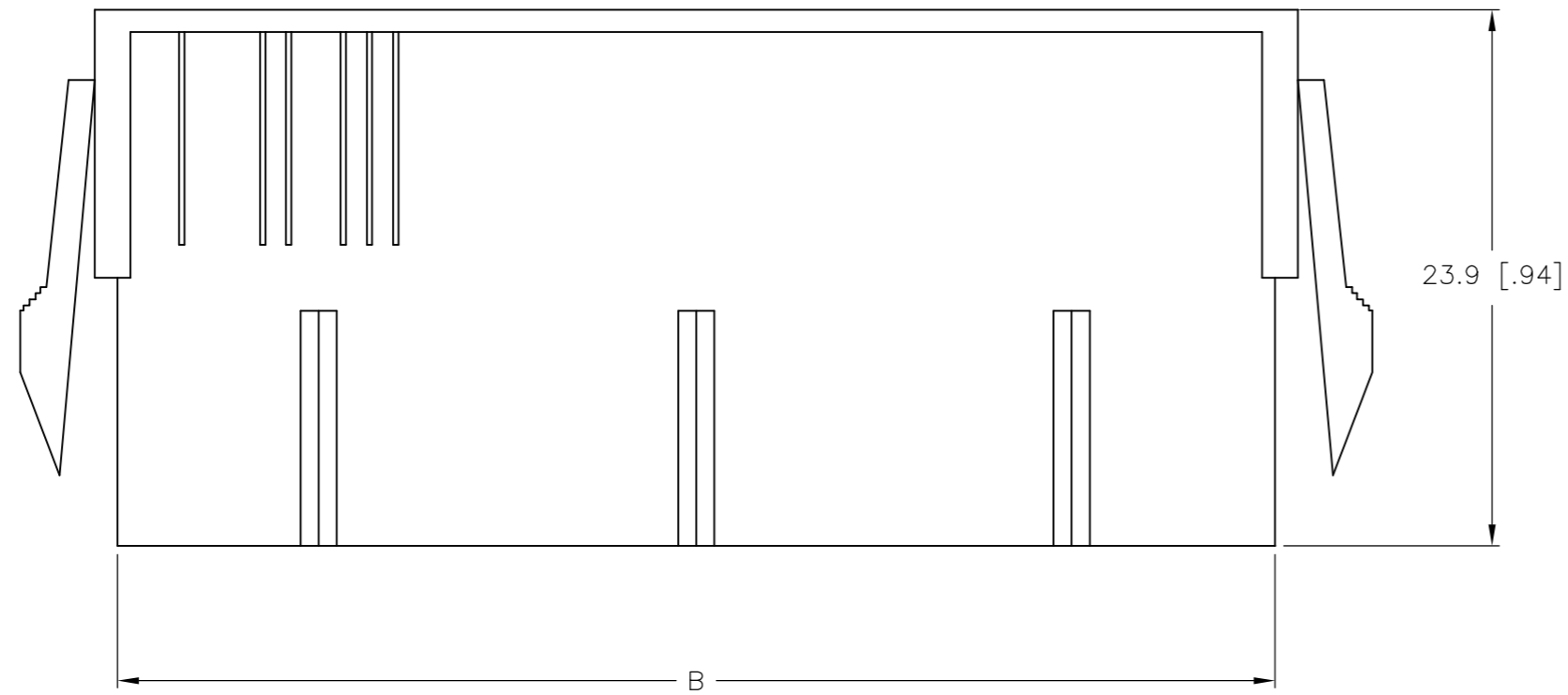
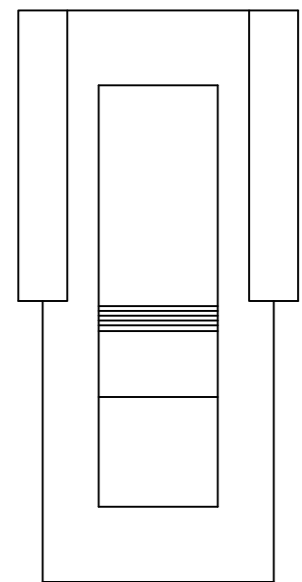
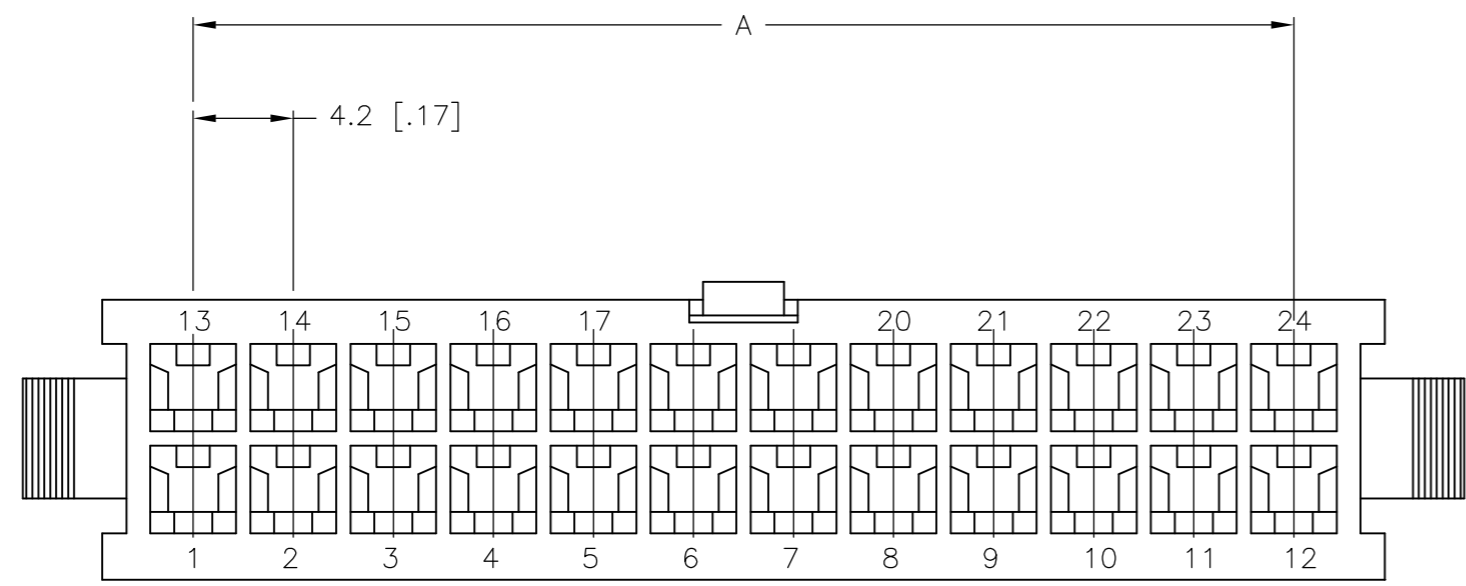
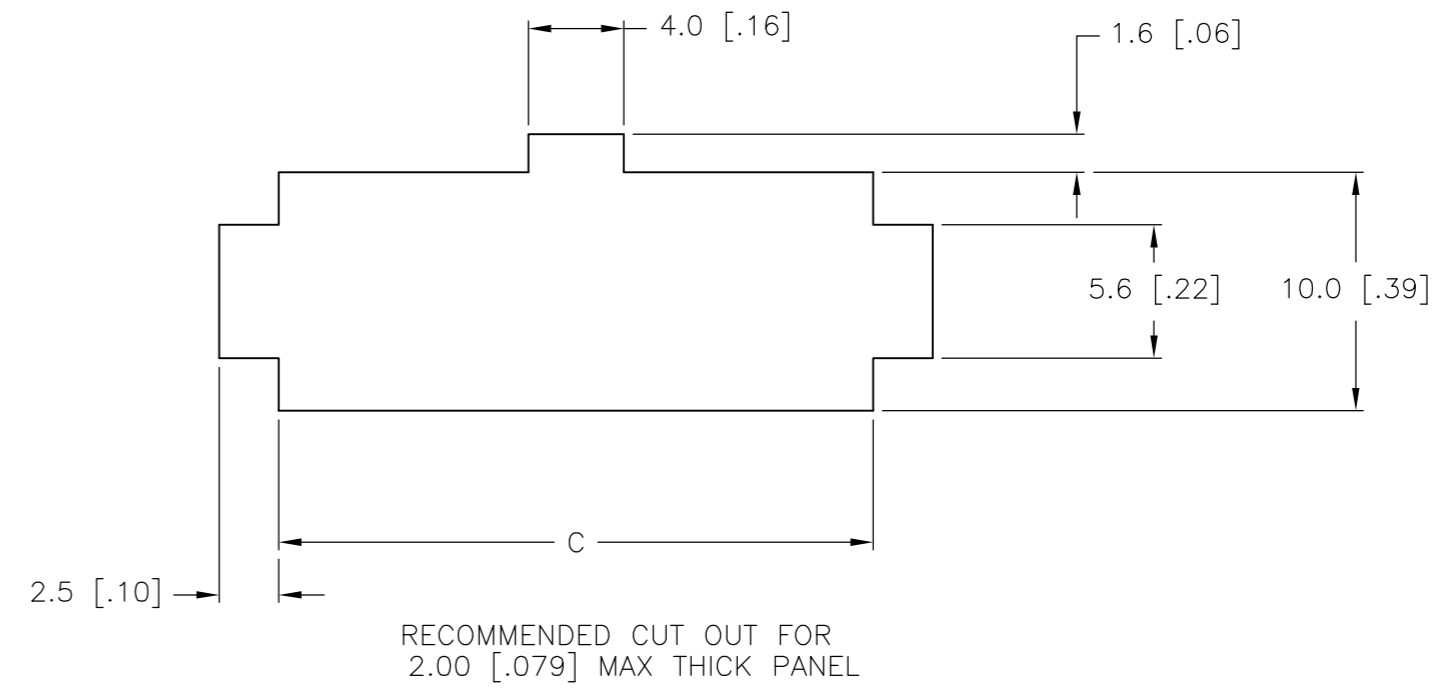
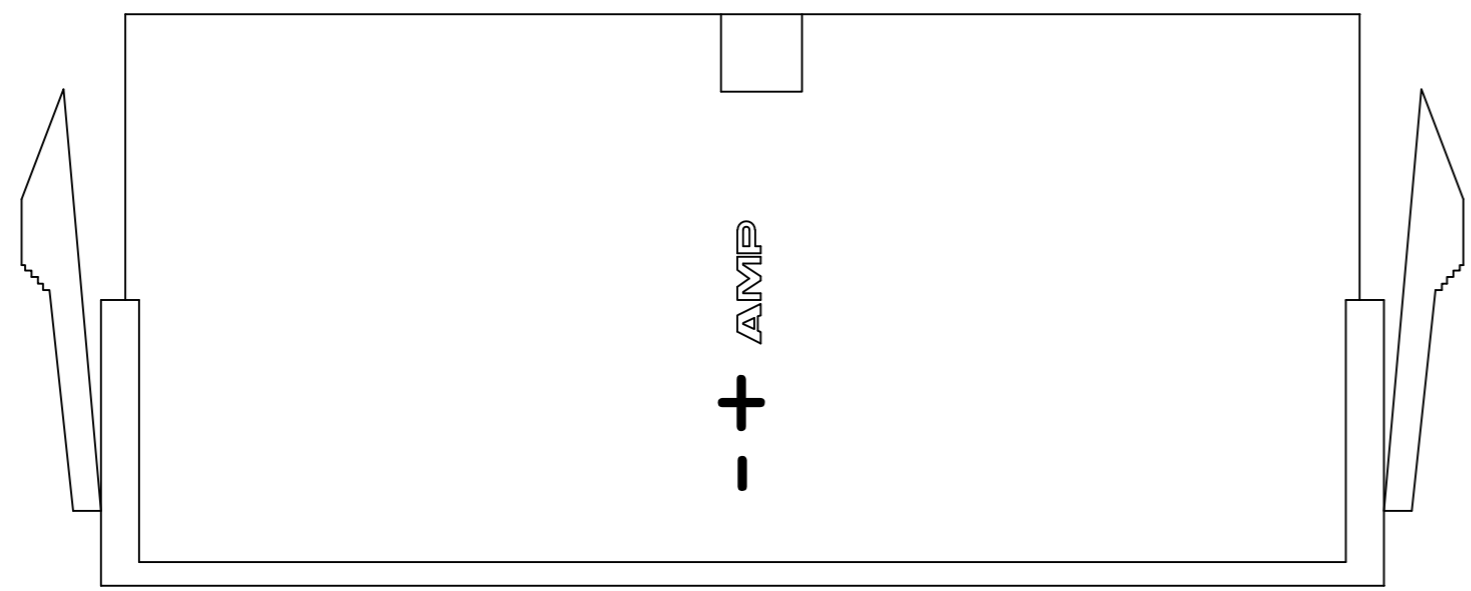
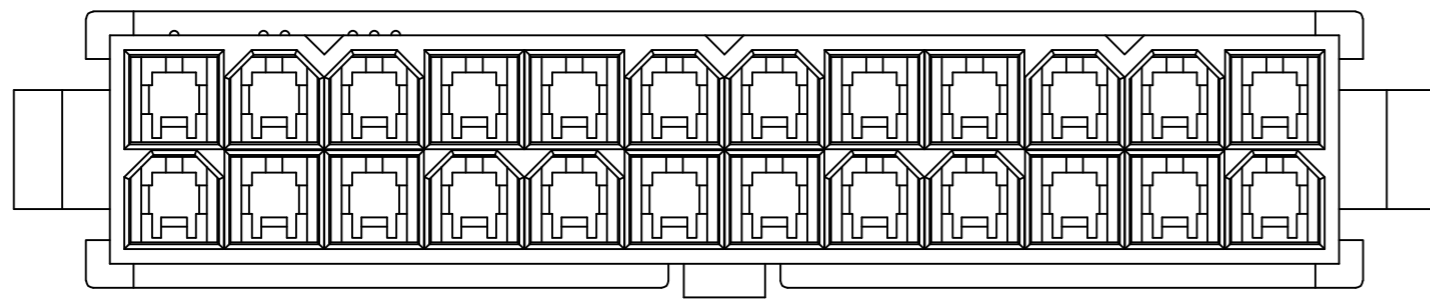

52.0	51.6	46.2	24	2-1586018-4
47.8	47.4	42.0	22	2-1586018-2
43.6	43.2	37.8	20	2-1586018-0
39.4	39.0	33.6	18	1-1586018-8
35.2	34.8	29.4	16	1-1586018-6
31.0	30.6	25.2	14	1-1586018-4
26.8	26.4	21.0	12	1-1586018-2
22.6	22.2	16.8	10	1-1586018-0
18.4	18.0	12.6	8	1586018-8
14.2	13.8	8.4	6	1586018-6
10.0	9.6	4.2	4	1586018-4
5.8	5.4	--	2	1586018-2
DIM C	DIM B	DIM A	POS	PART NUMBER

THIS DRAWING IS A CONTROLLED DOCUMENT.

DIMENSIONS: mm	TOLERANCES UNLESS OTHERWISE SPECIFIED: 0 PLC ± - 1 PLC ± 0.4 [0.02] 2 PLC ± 0.25 [0.010] 3 PLC ± 0.150 [0.0059] 4 PLC ± - ANGLES ± -	DWN S. HAMM 31-JUL-2002 CHK D. COLEY 31-JUL-2002 APVD D. COLEY 31-JUL-2002 PRODUCT SPEC APPLICATION SPEC	Tyco Electronics Corporation Harrisburg, PA 17105-3608	
MATERIAL 1	FINISH	WEIGHT	SIZE A2	CAGE CODE 00779
CUSTOMER DRAWING			DRAWING NO C=1586018	RESTRICTED TO -
			SCALE	SHEET 1 OF 1
			REV A	