

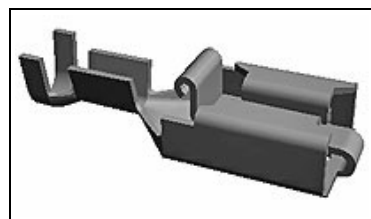

170234-2 Product Details

[Share](#) |
 [Print](#) |
 [Email](#)



170234-2

Positive Lock Connectors

Always EU RoHS/ELV Compliant (Statement of Compliance)

Product Highlights:

- Contact
- Contact Type = Socket
- Mating Area Interface Dimensions = 6.35 x 0.81 mm
- Applies To Wire/Cable
- Line = AMP POSITIVE LOCK Mark I

[View all Features](#)

Quick Links

- ▶ [Pricing & Availability](#)
- ▶ [Search for Tooling](#)
- ▶ [Product Feature Selector](#)
- ▶ [Contact Us About This Product](#)

TE Internal Number: 170234-2

Active

[View 3D PDF](#)

[Add to My Part List](#) |
 [Request Sample](#) |
 [Find Similar Products](#) |
 [Buy Product](#)

Documentation & Additional Information

Product Drawings:

- [250 POSITIVE LOCK RECEPTACLE \(PDF, Japanese\)](#)

Catalog Pages/Data Sheets:

- None Available

Product Specifications:

- [1-Position, Positive Lock Connector \(PDF, English\)](#)
- [MODULAR TERMINAL BLOCK \(PDF, English\)](#)
- [MODULAR TERMINAL BLOCK \(PDF, Japanese\)](#)

Application Specifications:

- [Crimping of Positive Lock Receptacle Contact \(PDF, English\)](#)

Instruction Sheets:

- None Available

CAD Files: (CAD Format & Compression Information)

- [2D Drawing \(DXF, Version K\)](#)
- [3D Model \(IGES, Version K\)](#)
- [3D Model \(STEP, Version K\)](#)

Additional Information:

- [Product Line Information](#)

Related Products:

- [Tooling](#)

[List all Documents](#)

Product Features (Please use the Product Drawing for all design activity)

Product Type Features:

- [Product Type](#) = Contact
- [Receptacle Style](#) = Straight
- [Finish](#) = Tin
- [Keyed](#) = No

Dimensions:

- [Mating Area Interface Dimensions \(mm \[in\]\)](#) = 6.35 x 0.81 [.250 x .032]
- [Insulation Diameter \(mm \[in\]\)](#) = 3.78-4.90 [.149-.192]

Body Features:

- [Wire Range \(mm \[AWG\]\)](#) = 3.00-6.00² [12-10]
- [Material](#) = Brass
- [Position Keyed](#) = None
- [Stock Thickness \(mm \[in\]\)](#) = 0.38 [0.015]

Contact Features:

- [Contact Type](#) = Socket

Industry Standards:

- [RoHS/ELV Compliance](#) = RoHS compliant, ELV compliant
- [Lead Free Solder Processes](#) = Not relevant for lead free process
- [RoHS/ELV Compliance History](#) = Always was RoHS compliant

Conditions for Usage:

- [Applies To](#) = Wire/Cable

Packaging Features:

- [Packaging Method](#) = Strip

Other:

- [Line](#) = AMP POSITIVE LOCK Mark I
- [Brand](#) = AMP

Corporate Information

[About TE](#)
[Investors](#)
[News Room](#)

Quick Links

[Distributor Inventory](#)
[Product Cross Reference](#)
[Documents & Drawings](#)

Customer Support

[Email or Chat With Us](#)
[Find a Phone Number](#)
[Knowledge Base](#)

Keep Me Informed



Feedback

[Supplier Portal](#)

[Careers](#)

[Terms & Conditions](#)

[Privacy Policy](#)

[AODA Accessibility Policy](#)

[AODA Multi-Year Accessibility
Plan](#)

[Product Compliance Support Center](#)

[Site Map](#)

[Manage Your Account](#)

