

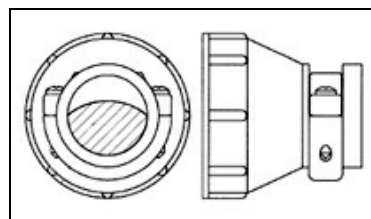

182655-1 Product Details



182655-1

CPC Accessories

Always EU RoHS/ELV Compliant (Statement of Compliance)

Product Highlights:

- Accessory Type = Cable Clamp
- Shell Size = 17
- Body Style = Straight
- Cable Diameter (Max.) = 11.51 mm
- Thermoplastic Cable Clamp Material

[View all Features](#)

TE Internal Number: 182655-1

Active

[Add to My Part List](#) [Request Sample](#) [Find Similar Products](#) [Buy Product](#)

Quick Links

- ▶ [Pricing & Availability](#)
- ▶ [Search for Tooling](#)
- ▶ [Product Feature Selector](#)
- ▶ [Contact Us About This Product](#)

Documentation & Additional Information

Documents are temporarily unavailable. We are working hard to correct the problem. Please try again later.

Additional Information:

- [Product Line Information](#)

Additional Product Images:

- [Product Usage](#)
- [Product Usage](#)
- [Product Usage](#)

Related Products:

- [Tooling](#)

Feedback

Product Features (Please use the Product Drawing for all design activity)

Product Type Features:

- [Accessory Type](#) = Cable Clamp
- [Shell Size](#) = 17
- [Thread Size](#) = 15/16-20

Dimensions:

- [Cable Diameter \(Max.\) \(mm \[in\]\)](#) = 11.51 [0.453]

Body Features:

- [Body Style](#) = Straight
- [Cable Clamp Material](#) = Thermoplastic
- [Cover](#) = Without
- [Cable Clamp Color](#) = Black
- [Cable Clamp Flammability Rating](#) = UL94V-0

Industry Standards:

- [RoHS/ELV Compliance](#) = RoHS compliant, ELV compliant
- [Lead Free Solder Processes](#) = Not relevant for lead free process
- [RoHS/ELV Compliance History](#) = Always was RoHS compliant

Packaging Features:

- [Packaging Method](#) = Individual
- [Packaging Quantity](#) = 25

Other:

- [Brand](#) = AMP

Corporate Information

- [About TE](#)
- [Investors](#)
- [News Room](#)
- [Supplier Portal](#)
- [Careers](#)
- [Terms & Conditions](#)
- [Privacy Policy](#)
- [AODA Accessibility Policy](#)
- [AODA Multi-Year Accessibility Plan](#)

Quick Links

- [Distributor Inventory](#)
- [Product Cross Reference](#)
- [Documents & Drawings](#)
- [Product Compliance Support Center](#)
- [Site Map](#)

Customer Support

- [Email or Chat With Us](#)
- [Find a Phone Number](#)
- [Knowledge Base](#)
- [Manage Your Account](#)

Keep Me Informed



