

DO NOT SCALE
DIMENSIONS IN mm

METRIC

THIRD ANGLE
PROJECTION

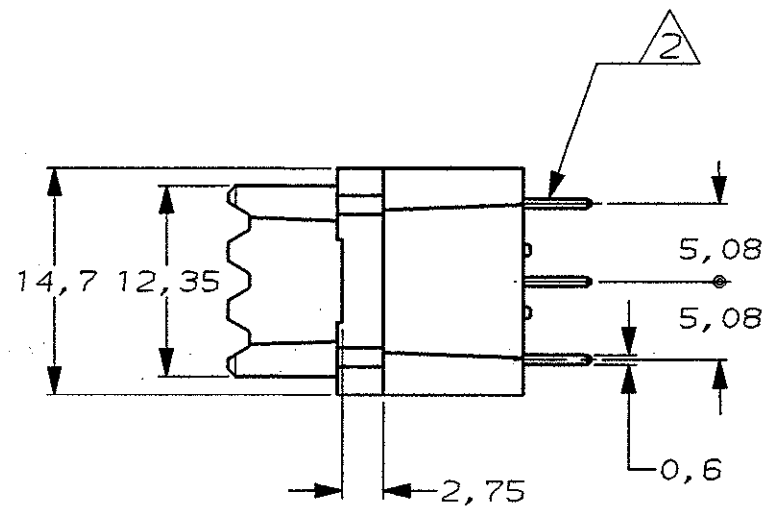
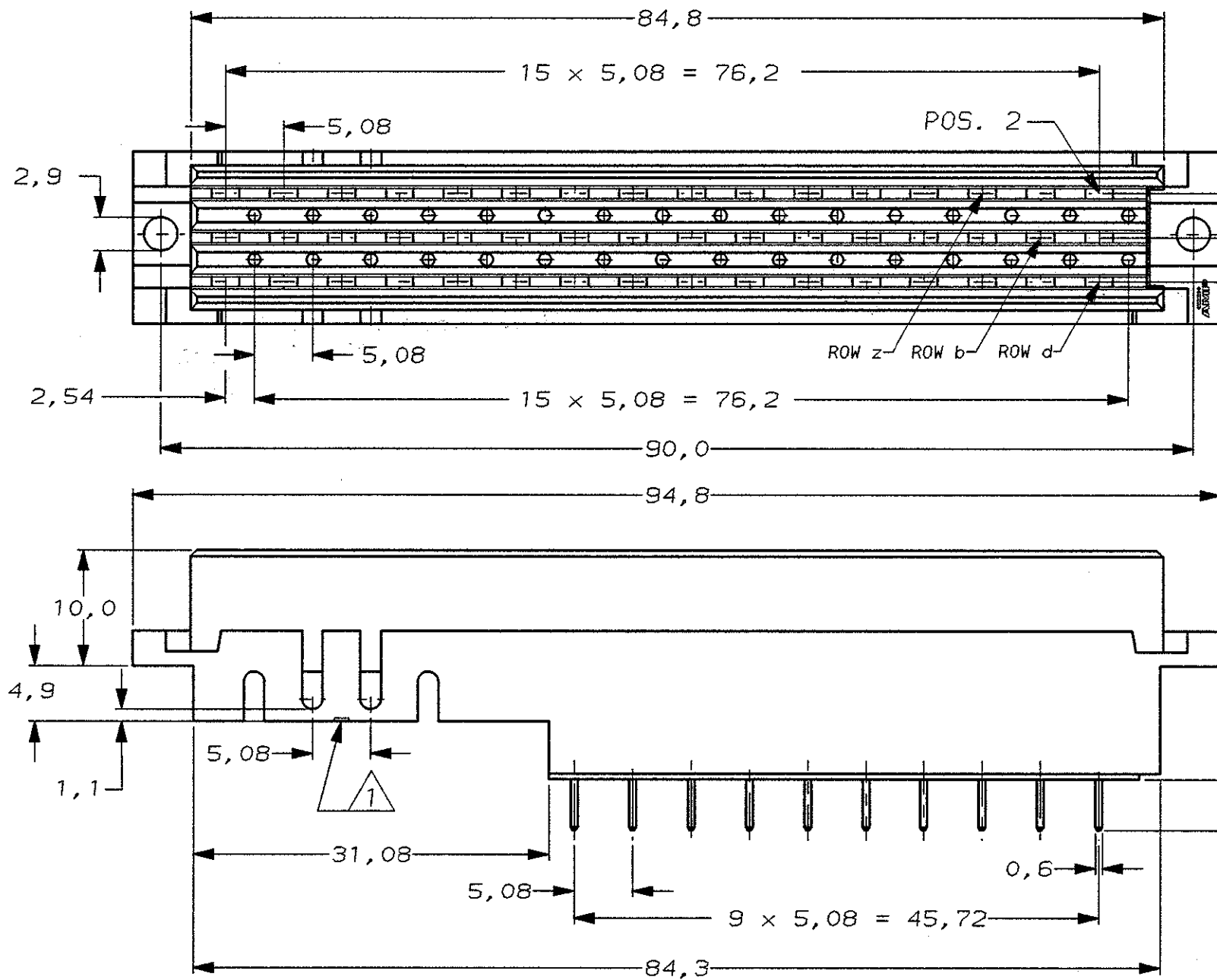

NOTES:

- ① 2 CHAMFERS AT INSIDE FOR LOCATION OF REMOVAL TOOL FOR MODULE p.n.216519-1
- ② SOLDERPOSTS SUITABLE FOR 0,80 OR 1,0 NOM. DIA HOLES

X	X	X	X	X	X	X	X	X	X	X	d	ROW								
X	X	X	X	X	X	X	X	X	X	X	b	ROW								
X	X	X	X	X	X	X	X	X	X	X	z	ROW								
20	19	18	17	16	15	14	13	12	11	10	9	8	7	6	5	4	3	2	1	POS.

AN ASTERISK ,,X'' DENOTES A CONTACT

AT CONTACT AREA 0,8 μm Au OVER 1,25 μm Ni AT SOLDERPOSTS; 2,5 μm Sn/Pb OVER 1,25 μm Ni	HOUSING: THERMOPL. POLYESTER G.F. COLOUR: GREY CONTACTS: PHOSPHORBRONZE	216520-4
FINISH	MATERIAL	PARTNUMBER

CUSTOMER DRAWING			FOR REFERENCE ONLY WILL NOT BE UPDATED	
© COPYRIGHT 19- BY AMP HOLLAND B.V. ALL INTERNATIONAL RIGHTS RESERVED. AMP PRODUCTS MAY BE COVERED BY U.S. AND FOREIGN AND/OR PATENTS PENDING. THIS DRAWING IS UNPUBLISHED RELEASED FOR PUBLICATION				
AMP			AMP HOLLAND B.V. s-Hertogenbosch, The Netherlands.	
C	EH-0837-94	LvdH	JvG	16 NOV '94
LTR.	REVISION RECORD	DR.	CHK.	DATE
DR.: L.V.D. HEIJDEN	CHK.: J.J. GUNSVEN	APP.: Y. SOEST	DWG. No. C-216520	
DATE: 15 NOV. 1994	DATE: 17.11.94	DATE: 20.11.94	REV. LTR. C	SHEET 1 OF 1

F
E
D
C
B
A

- [Home](#)
- [Part Number Search](#)
- [Text Search](#)
- [Alternate Part Search](#)
- [Multiple Part Comparison](#)
- [Alphabetical Search](#)
- [Brand Search](#)
- [Industry Product Search](#)
- [Product Type Search](#)
- [Product Family Search](#)
- [Competitor Cross Reference](#)
- [Document Number Search](#)
- [Lead Free Solutions](#)
- [Help/Glossary](#)

Current Brand View	AMP	View All Tyco Electronics Brands <small>Click to activate links to all other products</small>
---------------------------	---------------------	--

**.100 & .200 Centerline DIN 41612 Connectors (Eurocard)
Eurocard Type F and Type G Connectors .200
Centerline - 3 Row "Power" Applications**

[AMP](#) **216520-4** -- 2 of 2 products [Active](#) [Active](#)

(Tyco Electronics P/N: 216520-4)

Previous	Sales Information	AMP ACES	Step Search Screen
		Related Documents	General Information
		Pricing	Product Availability

Please use the customer drawing for all design activity.

- **Customer Drawing: 216520, Rev. C**
 Document Title: 3x10 positions female connector with solder posts with feature for crimp-on snap-in module 3x6 positions

[217538.pdf](#) [217538.pdf](#) (59K)

The photographs and/or line drawings below are representative images of a product for viewing purposes only.

[PCB Layout](#)

Searchable Features:

Brand:	AMP
Product Type:	Connector
Mating Type:	Receptacle
No. of Positions:	30
No. of Rows:	3
Post Type:	Solder Post
Mount Angle:	Vertical
Termination Post Length (mm [in]):	4.50 [.177]
Panel Attachment:	Yes
Rows Loaded:	B, D, Z
Make First / Break Last:	No
Interface I:	No
DIN Level:	II
Pre-notched to Break Off:	No
Product Style:	Type F

Other Properties:

Contact Retention in Housing:	Crimp Snap-In
Contact Material:	Phosphor Bronze
Housing Material:	Glass-Filled Thermoplastic Polyester
Color:	Gray
Housing Flammability Rating:	UL 94V-0

[Copyright](#) and [Privacy Statement](#)

Visit [Tyco International, Ltd.](#)

[Products](#) | [Brands](#) | [Industries](#) | [Customer Service](#) | [About](#) | [Home](#)