

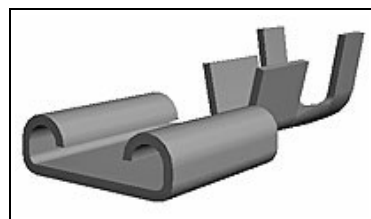

2232247-1 Product Details

[Share](#) [Print](#) [Email](#)



2232247-1

FASTON Uninsulated Receptacles & Housings

Always EU RoHS/ELV Compliant (Statement of Compliance)

Product Highlights:

- Terminal
- Terminal Type = Receptacle
- Mating Area Interface Dimensions = 6.35 x 0.80 mm
- Board Mount = No
- Receptacle Style = Straight

[View all Features](#)

Quick Links

- ▶ [Pricing & Availability](#)
- ▶ [Search for Tooling](#)
- ▶ [Product Feature Selector](#)
- ▶ [Contact Us About This Product](#)

TE Internal Number: 2232247-1

Active

[Add to My Part List](#) [Request Sample](#) [Find Similar Products](#) [Buy Product](#)

Documentation & Additional Information	
<p>Product Drawings:</p> <ul style="list-style-type: none"> • 250 series faston receptacle (PDF, English) <p>Catalog Pages/Data Sheets:</p> <ul style="list-style-type: none"> • None Available <p>Product Specifications:</p> <ul style="list-style-type: none"> • None Available <p>Application Specifications:</p> <ul style="list-style-type: none"> • None Available <p>Instruction Sheets:</p> <ul style="list-style-type: none"> • None Available <p>CAD Files:</p> <ul style="list-style-type: none"> • None Available 	<p>Related Products:</p> <ul style="list-style-type: none"> • Tooling
<p>List all Documents</p>	

Product Features (Please use the Product Drawing for all design activity)	
<p>Product Type Features:</p> <ul style="list-style-type: none"> • Product Type = Terminal • Receptacle Style = Straight • Insulation Support = Insulation Support • Wire/Cable Type = Stranded • Insertion Force = Normal • Finish = Tin <p>Mechanical Attachment:</p> <ul style="list-style-type: none"> • Board Mount = No <p>Termination Features:</p> <ul style="list-style-type: none"> • Crimp Type = F-Crimp <p>Dimensions:</p> <ul style="list-style-type: none"> • Mating Area Interface Dimensions (mm [in]) = 6.35 x 0.80 [.250 x .031] • Insulation Diameter (mm [in]) = 3.00-5.00 [.118-.196] <p>Body Features:</p> <ul style="list-style-type: none"> • Weld Tab = Without • Wire Range (mm [AWG]) = 1.60-6.00² [15-10] • Material = Brass 	<p>Contact Features:</p> <ul style="list-style-type: none"> • Terminal Type = Receptacle <p>Industry Standards:</p> <ul style="list-style-type: none"> • RoHS/ELV Compliance = RoHS compliant, ELV compliant • Lead Free Solder Processes = Not relevant for lead free process • RoHS/ELV Compliance History = Always was RoHS compliant • UL Rating = Listed • CSA Certified = Yes <p>Conditions for Usage:</p> <ul style="list-style-type: none"> • For Hermetic Header Tab = No <p>Packaging Features:</p> <ul style="list-style-type: none"> • Packaging Method = Strip <p>Other:</p> <ul style="list-style-type: none"> • Line = Commercial • Brand = AMP



[Supplier Portal](#)

[Product Compliance Support Center](#)

[Manage Your Account](#)



[Careers](#)

[Site Map](#)

[Terms & Conditions](#)

[Privacy Policy](#)

[AODA Accessibility Policy](#)

[AODA Multi-Year Accessibility
Plan](#)