

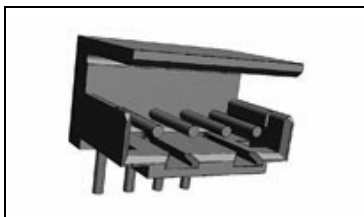

## 292164-2 Product Details



**292164-2**

### 2mm AMP CT Connectors

Always EU RoHS/ELV Compliant (Statement of Compliance)

#### Product Highlights:

- Wire-to-Board
- Applies To Printed Circuit Board
- Connector
- Header
- Header Type = Shrouded

[View all Features](#)

#### Quick Links

- ▶ [Pricing & Availability](#)
- ▶ [Search for Tooling](#)
- ▶ [View Mating Products \(3\)](#)
- ▶ [Product Feature Selector](#)
- ▶ [Contact Us About This Product](#)

TE Internal Number: 292164-2

Active

[View 3D PDF](#)

[Add to My Part List](#) | [Request Sample](#) | [Find Similar Products](#) | [Buy Product](#)

### Documentation & Additional Information

#### Product Drawings:

- [TUBE PACKING AMP CT CONN. POST HDR ASS'Y \(BOX-H DIP\)](#) (PDF, English)

#### Catalog Pages/Data Sheets:

- [2.0MM\\_AMP\\_CT\\_CONNECTOR\\_SERIES\\_QUICK\\_REF\\_GUIDE](#) (PDF, English)

#### Product Specifications:

- None Available

#### Application Specifications:

- None Available

#### Instruction Sheets:

- None Available

#### CAD Files: (CAD Format & Compression Information)

- [2D Drawing](#) (DXF, Version 0)
- [3D Model](#) (IGES, Version 0)
- [3D Model](#) (STEP, Version 0)

#### Additional Product Images:

- [Typical Application](#)

#### Related Products:

- [Tooling](#)
- [Mating Products \(3\)](#)

[List all Documents](#)

### Product Features (Please use the Product Drawing for all design activity)

#### Product Type Features:

- [Product Type](#) = Connector
- Connector Type = Header
- PCB Mounting Orientation = Right Angle
- PCB Mount Alignment = Without
- [PCB Mount Retention](#) = With
- PCB Mount Retention Type = Kinked Leg(s)
- Sealed = No
- CSA File Number = LR 7189

#### Electrical Characteristics:

- Contact - Rated Current (A) = 4
- Operating Voltage Reference = AC/DC, AC, DC
- Operating Voltage (VAC) = 125
- Operating Voltage (VDC) = 125

#### Termination Features:

- Wire/Cable Size (AWG) = 22 - 28
- Termination Method to PC Board = Through Hole - Solder

#### Dimensions:

- Mating Post Length (mm [in]) = 4.20 [0.165]
- PCB Thickness, Recommended (mm [in]) = 0.80 - 1.60 [0.031 - 0.063]
- Tail Length (mm [in]) = 3.2 [0.126]
- Length (X-Axis) (mm [in]) = 5.80 [0.228]
- Width (Z-Axis) (mm [in]) = 5.80 [0.228]
- Profile Height (Y-Axis) (mm [in]) = 8.80 [0.346]

#### Housing Features:

- Connector Style = Plug
- Centerline (mm [in]) = 2.00 [0.079]
- Housing Color = Natural

#### Configuration Features:

- [Number of Positions](#) = 2
- [Number of Rows](#) = 1
- Tail Orientation = In-line
- Shrouded = Yes

#### Industry Standards:

- [RoHS/ELV Compliance](#) = RoHS compliant, ELV compliant
- [Lead Free Solder Processes](#) = Wave solder capable to 260°C, Wave solder capable to 240°C, Wave solder capable to 265°C
- RoHS/ELV Compliance History = Always was RoHS compliant
- UL Flammability Rating = UL 94V-0
- Agency/Standard = UL, CSA
- UL File Number = E28476

#### Environmental:

- Operating Temperature (°C [°F]) = -40 - +105 [-40 - +221]

#### Conditions for Usage:

- Applies To = Printed Circuit Board

#### Operation/Application:

- Application Use = Wire-to-Board
- Contact Transmits (Typical Application) = Signal (Data)

**Body Features:**

- Header Type = Shrouded
- Mating Retention = Without

**Contact Features:**

- Contact Type = Pin
- Contact Plating, Mating Area, Material = Tin
- Contact Plating, Mating Area, Thickness ( $\mu\text{m}$  [ $\mu\text{in}$ ]) = 1 [39.37]
- Contact Plating, Termination Area, Material = Tin
- Contact Plating, Termination Area, Thickness ( $\mu\text{m}$  [ $\mu\text{in}$ ]) = 1 [39.37]

- Pick and Place Cover = Without

**Packaging Features:**

- Packaging Method = Tube, Box

**Other:**

- Brand = AMP

**Corporate Information**

[About TE](#)  
[Investors](#)  
[News Room](#)  
[Supplier Portal](#)  
[Careers](#)  
[Terms & Conditions](#)  
[Privacy Policy](#)  
[AODA Accessibility Policy](#)  
[AODA Multi-Year Accessibility Plan](#)

**Quick Links**

[Distributor Inventory](#)  
[Product Cross Reference](#)  
[Documents & Drawings](#)  
[Product Compliance Support Center](#)  
[Site Map](#)

**Customer Support**

[Email or Chat With Us](#)  
[Find a Phone Number](#)  
[Knowledge Base](#)  
[Manage Your Account](#)

**Keep Me Informed**