

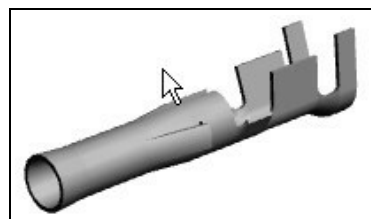

350415-5 Product Details



350415-5

.198, .200, .250" Centerline, 250 V, 13 A max.

Always EU RoHS/ELV Compliant (Statement of Compliance)

Product Highlights:

- Commercial Pin & Socket Product Line
- Wire-to-Wire
- Contact
- Contact Type = Socket
- Wire/Cable Size = .5 - 2 mm²

[View all Features](#)

TE Internal Number: 350415-5

Active

[View 3D PDF](#)

[Add to My Part List](#) | [Request Sample](#) | [Find Similar Products](#) | [Buy Product](#)

Quick Links

- ▶ [Pricing & Availability](#)
- ▶ [Search for Tooling](#)
- ▶ [View Housings \(66\)](#)
- ▶ [Product Feature Selector](#)
- ▶ [Contact Us About This Product](#)

Documentation & Additional Information

Product Drawings:

- [.093 SOCKET COMMERCIAL PIN AND SOCKET \(PDF, English\)](#)

Catalog Pages/Data Sheets:

- [SOFT_SHELL_PIN_SOCKET_CONNECTORS_STANDARD_DENSITY \(PDF, English\)](#)

Product Specifications:

- [.093 Diameter Commercial Pin and Socket Connector \(PDF, English\)](#)

Application Specifications:

- [.093 Diameter Pin and Socket Contacts and Housings \(PDF, English\)](#)

Instruction Sheets:

- None Available

CAD Files: (CAD Format & Compression Information)

- [2D Drawing \(DXF, Version AL\)](#)
- [3D Model \(IGES, Version AL\)](#)
- [3D Model \(STEP, Version AL\)](#)

[List all Documents](#)

Related Products:

- [Tooling](#)
- [Housings \(66\)](#)

Product Features (Please use the Product Drawing for all design activity)

Product Type Features:

- Product Line = Commercial Pin & Socket
- Product Type = Contact
- Wire/Cable Type = Discrete Wire

Mechanical Attachment:

- Contact Retention = Yes
- Contact Retention Type = Locking Lance

Electrical Characteristics:

- Operating Voltage (VAC) = 250, 600
- Contact - Rated Current (A) = 13
- Operating Voltage Reference = AC

Termination Features:

- Wire/Cable Size (mm²) = 0.5 - 2
- Wire/Cable Size (AWG) = 14 - 20
- Termination Method to Wire/Cable = Crimp

Body Features:

- Wire Type = Stranded

Contact Features:

- Contact Type = Socket
- Contact Base Material = Brass
- Contact Plating, Mating Area, Material = Select Gold
- Contact Plating, Mating Area, Thickness (µm [µin]) = 0.76 [29.92]
- Contact Diameter (mm [in]) = 2.36 [0.093]
- Underplate Material = Nickel

Industry Standards:

- [RoHS/ELV Compliance](#) = RoHS compliant, ELV compliant
- [Lead Free Solder Processes](#) = Not relevant for lead free process
- [RoHS/ELV Compliance History](#) = Always was RoHS compliant

Environmental:

- Operating Temperature (°C [°F]) = -55 - +105 [-67 - +221]

Conditions for Usage:

- Accepts Wire Insulation Diameter, Range (mm [in]) = 3.56 [0.1402]
- For Use With = Pin

Operation/Application:

- Application Use = Wire-to-Wire

Packaging Features:

- Packaging Method = Reel
- Packaging Quantity = 4,000

Other:

- Brand = AMP

- Underplate Material Thickness (μm [μin]) = 1.27 [50.000]

Corporate Information

[About TE](#)
[Investors](#)
[News Room](#)
[Supplier Portal](#)
[Careers](#)
[Terms & Conditions](#)
[Privacy Policy](#)
[AODA Accessibility Policy](#)
[AODA Multi-Year Accessibility Plan](#)

Quick Links

[Distributor Inventory](#)
[Product Cross Reference](#)
[Documents & Drawings](#)
[Product Compliance Support Center](#)
[Site Map](#)

Customer Support

[Email or Chat With Us](#)
[Find a Phone Number](#)
[Knowledge Base](#)
[Manage Your Account](#)

Keep Me Informed

