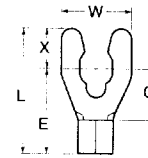

### Short Spring Spade Tongue Terminals

**Material and Finish:**
**Terminal Body** — Phosphor Bronze  
per ASTM B-103

**Plating** — Tin per MIL-T-10727

Wire Size Circular Mils [mm <sup>2</sup> ]	Stud Size	Dimensions					Material Thickness Max.	Wire Barrel I.D. Min.	Part Numbers
		L Max.	E Max.	C Min.	W	X			
22-16 509-3,260 [0.26-1.65]	4	.576 14.63	.431 10.95	.250 6.35	.203 5.16	.140 3.56	.033 0.84	.061 1.55	53175-1*
	6 M3.5	.576 14.63	.431 10.95	.250 6.35	.250 6.35	.140 3.56	.033 0.84	.061 1.55	53120-1* 53120-2
	8 M4	.637 16.18	.462 11.73	.281 7.14	.244 6.20	.170 4.32	.033 0.84	.061 1.55	53831-2
	10	.685 17.40	.462 11.73	.281 7.14	.294 7.47	.218 5.54	.033 0.84	.061 1.55	53832-2
16-14 2,050-5,180 [1.04-2.62]	6 M3.5	.576 14.63	.431 10.95	.250 6.35	.250 6.35	.140 3.56	.033 0.84	.085 2.16	53123-1* 53123-2
	8 M4	.637 16.18	.462 11.73	.281 7.14	.375 9.53	.170 4.32	.033 0.84	.085 2.16	53124-1* 53124-2
	10	.685 17.40	.462 11.73	.281 7.14	.406 10.31	.218 5.54	.033 0.84	.085 2.16	53125-1* 53125-2
		.685 17.40	.462 11.73	.281 7.14	.294 7.47	.218 5.54	.033 0.84	.085 2.16	53834-2
12-10 5,180-13,100 [2.62-6.64]	6 M3.5	.636 16.15	.452 11.48	.174 4.42	.250 6.35	.179 4.55	.042 1.07	.129 3.28	53126-1* 53126-2
	8 M4	.729 18.52	.554 14.07	.276 7.01	.312 7.92	.170 4.32	.042 1.07	.129 3.28	53835-1 53835-2
	10	.777 19.74	.554 14.07	.276 7.01	.406 10.31	.218 5.54	.042 1.07	.129 3.28	53128-1* 53128-2
		.777 19.74	.554 14.07	.276 7.01	.312 7.92	.218 5.54	.042 1.07	.129 3.28	53836-2

**Note:** Part numbers are shown as loose piece over tape mounted product.  
\* Part numbers are available in small quantity packages.

### Long Spring Spade Tongue Terminals

**Material and Finish:**
**Terminal Body** — Phosphor Bronze  
per ASTM B-103

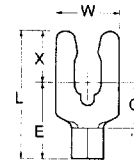
**Plating** — Tin per MIL-T-10727

Wire Size Circular Mils [mm <sup>2</sup> ]	Stud Size	Dimensions					Material Thickness Max.	Wire Barrel I.D. Min.	Part Numbers
		L Max.	E Max.	C Min.	W	X			
16-14 2,050-5,180 [1.04-2.62]	8 M4	.756 19.20	.461 11.71	.270 6.86	.281 7.14	.290 7.37	.033 0.84	.085 2.16	52713-1*
	10	.782 19.86	.474 12.04	.283 7.19	.343 8.71	.303 7.70	.033 0.84	.085 2.16	52714-1*
12-10 5,180-13,100 [2.62-6.64]	10	.896 22.76	.583 14.81	.305 7.75	.375 9.53	.308 7.82	.042 1.07	.129 3.28	52717-2

\* Part numbers are shown as loose piece over tape mounted product.

For complete product information, order Catalog 65505