

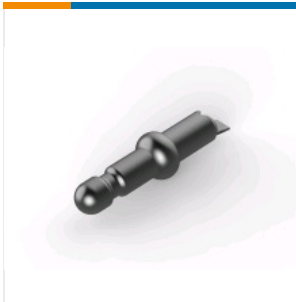

PCB TERMINALS



TE CONNECTIVITY (TE)

.058 DIA PIN PC PTPPHBZ

AMP-IN | AMP-IN and PC Board Disconnects

60824-1

TE Internal Number: 60824-1

Always EU RoHS/ELV Compliant

Terminal Style **Receptacle**

PCB Thickness (Recommended) **1.6 mm [.063 in]**

PCB Hole Diameter **1.7 – 1.85 mm [.067 – .073 in]**

Mating Pin Diameter **1.47 mm [.058 in]**

Material Thickness **.25 mm [.01 in]**

Active

PRODUCT DRAWING
English

3D PDF

Product Drawings

[PIN, .058 DIAMETER, PHOSPHER BRONZE, CLINCH FIT, P.C. CONTACT](#)

PDF (TIFF AVAILABLE)
English

[PIN, .058 DIAMETER, PHOSPHER BRONZE, CLINCH FIT, P.C. CONTACT](#)

PDF (TIFF AVAILABLE)
English

CAD Files

3D PDF

PDF
3D

Customer View Model

2D_DXF.ZIP
English

Customer View Model

3D_IGS.ZIP
English

Customer View Model

3D_STP.ZIP
English

Catalog Pages/Data Sheets

[PRINTED CIRCUIT BOARD TERMINALS AND DISCONNECTS](#)

PDF
English

Product Specifications

Product Specification

[.093 Diameter Printed Circuit Board Disconnect System](#)

PDF
English

[.058 Diameter Printed Circuit Board Disconnect System](#)

PDF
English

Application Specification

[.058 And .093 Diameter Printed Circuit \(PC\) Board Pins And Disconnect Receptacle Contacts](#)

PDF
English

Please review product documents or [contact us](#) for the latest agency approval information. Please Note: Use the Product Drawing for all design activity.

Product Type Features	Wire Cutoff	No
	Applies To	Printed Circuit Board
	Insulated Wire Support	No

Configuration Features	Stud Hole	No
	Terminal Angle	Straight

Body Features	Plating Material	Pre-Tin
---------------	------------------	----------------

Contact Features	Terminal Style	Receptacle
	Mating Pin Diameter	1.47 mm [.058 in]
	Terminal Orientation	Straight
	Contact Plating Material	Tin

Dimensions	PCB Thickness (Recommended)	1.6 mm [.063 in]
	PCB Hole Diameter	1.7 – 1.85 mm [.067 – .073 in]
	Material Thickness	.25 mm [.01 in]





Packaging Features	Packaging Method	Reel
	Packaging Quantity	10000

Product Compliance

[Statement of Compliance](#)
PDF

[VIEW ALL PRODUCT COMPLIANCE](#)

CUSTOMERS ALSO BOUGHT

<p>PCB TERMINALS</p>  <p>.058 PIN REC 24-20 010PTPPHBZ 60940-1</p> <p>Save to List</p> <p>Find Similar Products</p>	<p>STANDARD POWER RELAYS</p>  <p>RT424A12 RT424A12</p> <p>Save to List</p> <p>Find Similar Products</p>	<p>DIP & SIP SWITCHES</p>  <p>DIP SW 4 POSN SEALED 3-435640-5</p> <p>Save to List</p> <p>Find Similar Products</p>	<p>STANDARD POWER RELAYS</p>  <p>T90N1D12-24=T90- T90N1D12-24</p> <p>Save to List</p> <p>Find Similar Products</p>
---	---	--	--

