

**312 Series Receptacles**

**Straight Receptacles,  
Insulation Support**

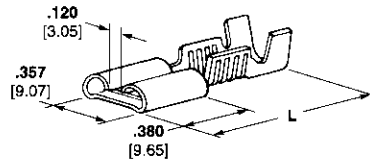

A — Premier Line

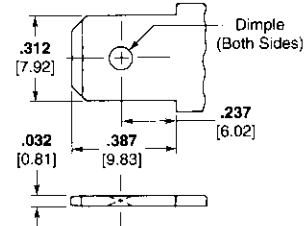

Mating 312 Series Tab Dimensions  
Dimple (Both Sides)

Wire Range AWG	Style	Tab Fit	Insulation Diameter	Material and Finish	Stock Thickness	L (Overall Length)	UL	UL	CSA	Terminal Part Number
18-14	A	.032 0.81	.090-.120 2.29-3.05	Brass	.016 0.41	.900 22.86	—	X	X	62092-1
		.032 0.81	.160 4.06	Brass, Tin plated	.016 0.41	.900 22.86	—	X	X	61399-1
		.032 0.81	.110 2.79	Brass, Silver Plated	.016 0.41	.900 22.86	—	X	X	63225-2
16-12	A	.032 0.81	.160 4.06	Brass, Tin plated	.016 0.41	.900 22.86	—	X	X	63677-1 <sup>1</sup>
		.032 0.81	.110 2.79	Brass	.016 0.41	.900 22.86	—	X	X	63677-2 <sup>1</sup>
14-10	A	.032 0.81	.150-.200 3.81-5.08	Brass, Silver Plated	.018 0.46	.900 22.86	—	X	X	63820-1

<sup>1</sup> Low Insertion Force

**250 Series Receptacles**

**Straight Receptacles,  
Insulation Support**

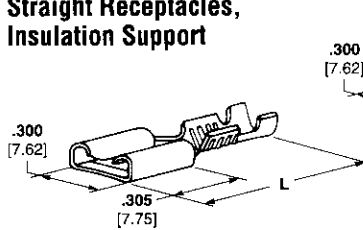

A — Premier Line

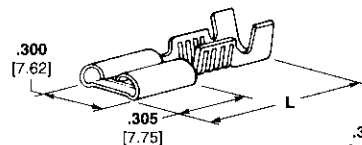

B — Budget Line

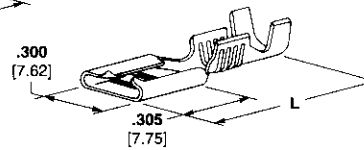

C — Economy Line

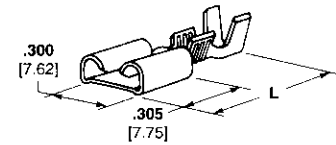

D — Moldable Line

Wire Range AWG	Style	Tab Fit	Insulation Diameter	Material and Finish	Stock Thickness	L (Overall Length)	UL	UL	CSA	Terminal Part Number
26-22	C	.032 0.81	.040-.060 1.02-1.52	Brass	.016 0.41	.755 19.18	X <sup>1</sup>	—	X <sup>1</sup>	61202-1
24-20	A	.032 0.81	.030-.070 0.76-1.78	Brass, Tin Plated	.016 0.41	.755 19.18	X <sup>2</sup>	—	X <sup>2</sup>	61368-1
		.032 0.81	.060-.100 1.52-2.54	Brass	.016 0.41	.755 19.18	X	—	X <sup>2</sup>	42640-1
		.032 0.81	.060-.100 1.52-2.54	Brass, Tin Plated	.016 0.41	.755 19.18	X	—	X	42640-2
		.032 0.81	.090-.130 2.29-3.30	Brass	.016 0.41	.755 19.18	X	—	X	41771
		.032 0.81	.090-.130 2.29-3.30	Brass, Tin Plated	.016 0.41	.755 19.18	X	—	X	41772
22-18	B	.032 0.81	.090-.130 2.29-3.30	Brass	.016 0.41	.755 19.18	X	—	X	42510-1
		.032 0.81	.090-.130 2.29-3.30	Brass, Tin Plated	.016 0.41	.755 19.18	X	—	X	42510-2
		.032 0.81	.090-.130 2.29-3.30	Brass	.016 0.41	.755 19.18	X	—	X	42743-1
		.032 0.81	.090-.130 2.29-3.30	Brass	.016 0.41	.755 19.18	X	—	X	42743-2
	D	.032 0.81	.090-.130 2.29-3.30	Brass, Tin Plated	.016 0.41	.750 19.05	—	—	—	63127-1

<sup>1</sup> UL listed and CSA certified for 22 AWG.

<sup>2</sup> UL listed and CSA certified for 22-20 AWG.

<sup>3</sup> Mates with a .020 [0.51] thick tab.

<sup>4</sup> 9,600 CMA max.

<sup>5</sup> UL/CSA - 10 AWG only.

<sup>6</sup> .012 [.030] stock (multiple circuit housings).

<sup>7</sup> Stress relieved.

<sup>8</sup> Recommended for external use only.

<sup>9</sup> Recommended for internal or external use.