

FASTON Printed Circuit Board Tabs and Receptacles (Continued)

.110 Series Printed Circuit Board

Stock Thickness — .020 [0.51]

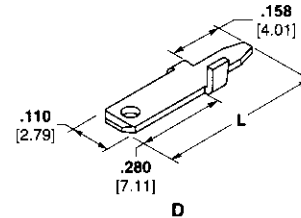
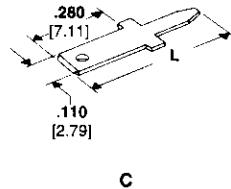
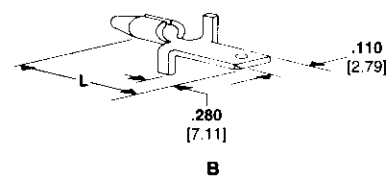
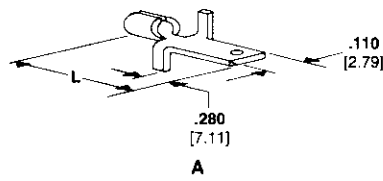

Style	Mating Hole Diameter	Dim. L	Material and Finish	UL	CSA	Terminal Part No.
A	.060-.055 1.52-1.40	.490 12.45	Tin Brass	X	X	61134-3 ¹
B	.067-.063 1.70-1.60	.485 12.32	Tin Brass	X	X	61968-1 ² 62437-1 ¹
C	.044-.048 1.12-1.22	.490 12.45	Tin Brass	X	X	62395-1 ²
		.622 15.80	Tin Brass	X	X	63756-1 ^{2,3}
		.910 23.11	Tin Brass	—	—	63794-1 ⁴
		.550 13.97	Tin/Lead	—	—	1217121-1 ¹
		.622 15.80	Tin Brass	—	—	1217514-1
D	.067-.073 1.70-1.85	.490 12.45	Pre-tin/ Pre-copper	X	X	62669-1 ²
	.062-.068 1.57-1.73	.545 13.84	Tin Brass	—	—	1217577-1 ²

¹ Loose piece only.
² Insertion machine available.
³ .032 [0.81] Stock.
⁴ .060 [1.52] Tab width.

Right Angle Printed Circuit Board Tabs

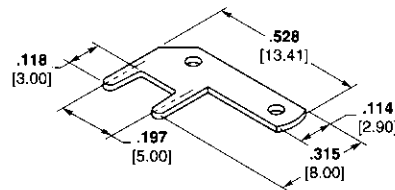

Tab Thickness	PCB Hole Dia. +0/-0.01 [+0/-0.03]	Material and Finish	UL	CSA	Terminal Part No.
.032 0.81	.055 1.40	Tin Plated Brass	—	—	725963-2
.020 0.51	.051 1.30	Tin Plated Brass	—	—	725996-2