

THIS DRAWING IS UNPUBLISHED. RELEASED FOR PUBLICATION
 © COPYRIGHT BY TYCO ELECTRONICS CORPORATION. ALL RIGHTS RESERVED.

LOC		DIST		REVISIONS			
P	LTR	DESCRIPTION		DATE	DWN	APVD	
	AH2	REVISED PER ECR-07-010057		07MAY07	HMR	KR	

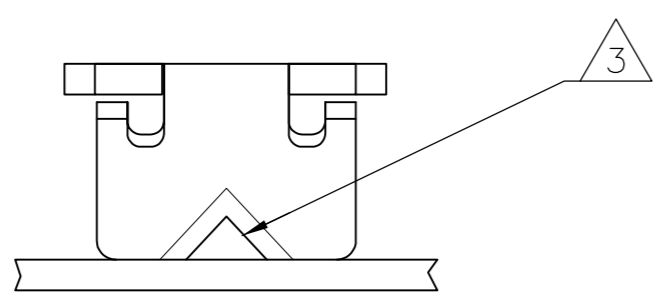

- 1 CONTINUOUS STRIP ON REELS WITH TERMINALS LOCATED ON 5.59±0.08 [.220±.003] CENTERS.
- 2 SLOT ACCEPTS EITHER A SINGLE OR DOUBLE MAGNET WIRE OF THE SAME SIZE AND TYPE. COPPER RANGE 0.36-0.57mm [#27-#23 AWG].
- 3 POKE-IN ACCEPTS A 0.50-0.90mm² [#20-#18] AWG SOLID OR FUSED STRANDED LEAD WIRE.
- 4 SPECIAL REEL QUANTITY - AMP SPAIN PRODUCTION ONLY.
- 5 PRELIMINARY - NOT FOR PRODUCTION.
- 6 FOREIGN PRODUCTION ONLY.

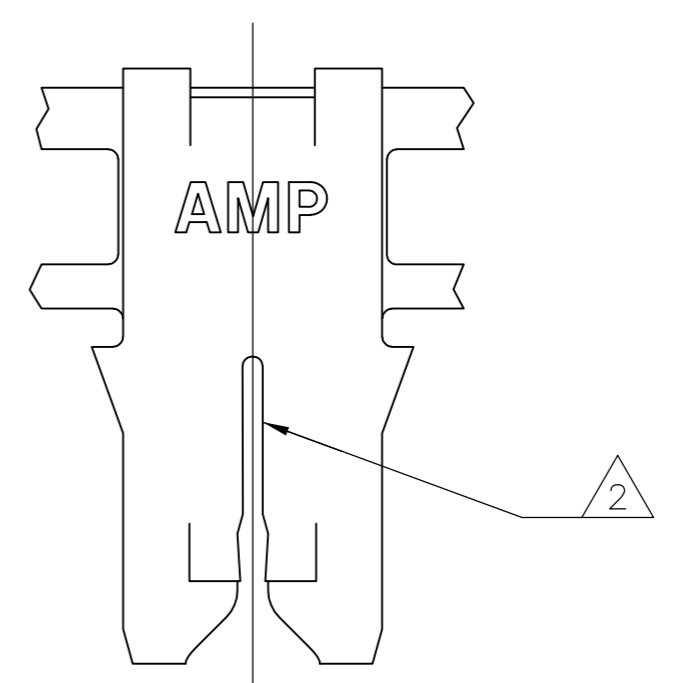
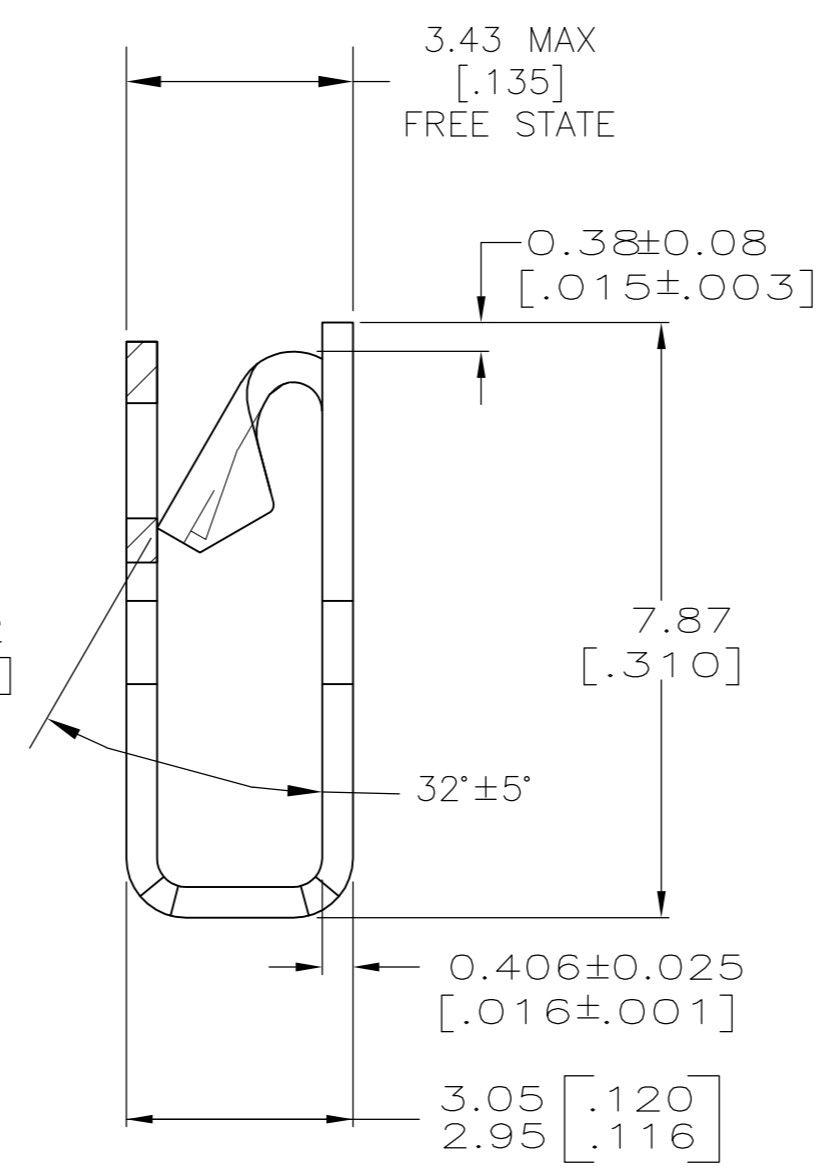
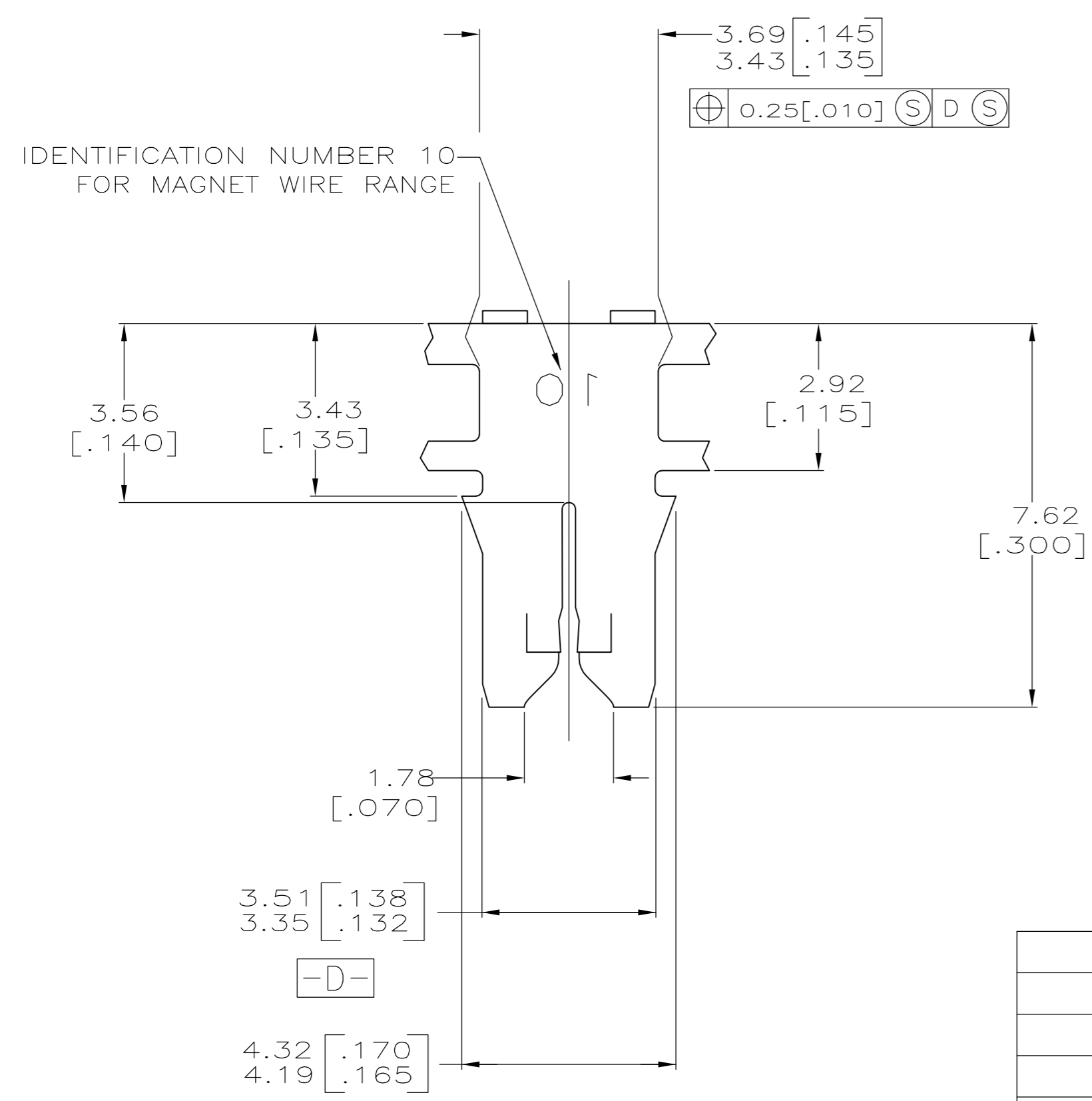

STANDARD	SPLICE	REELING	FINISH	PART NUMBER
STANDARD	PAPER SPLICE	WITHOUT PAPER	0.002032[.000080] MIN TIN PLATE	5 62935-8
STANDARD	SPLICE FREE	WITH PAPER	0.002032[.000080] MIN TIN PLATE	6 62935-7
REVERSE	WELD SPLICE	WITHOUT PAPER	0.002032[.000080] MIN TIN PLATE	5 62935-6
STANDARD	WELD SPLICE	WITHOUT PAPER	0.002032[.000080] MIN TIN PLATE	4 62935-5
STANDARD	SPLICE FREE	PLASTIC REEL W/O PAPER	0.002032[.000080] MIN TIN PLATE	62935-4
STANDARD	WELD SPLICE	WITH PAPER	0.002032[.000080] MIN TIN PLATE	62935-3
STANDARD	WELD SPLICE	PLASTIC REEL W/ PAPER	NONE	6 62935-2
STANDARD	WELD SPLICE	WITHOUT PAPER	0.002032[.000080] MIN TIN PLATE	62935-1
REELING DIRECTION	SPLICE	REELING	FINISH	PART NUMBER

THIS DRAWING IS A CONTROLLED DOCUMENT.

DWN MICHAEL S. FEHER 15MAR2004	Tyco Electronics Corporation Harrisburg, Pa 17105-3608
CHK KURT A. RANDOLPH 15MAR2004	
APVD KURT A. RANDOLPH 15MAR2004	
NAME KURT A. RANDOLPH	
DIMENSIONS: INCHES	PRODUCT SPEC 108-2012
TOLERANCES UNLESS OTHERWISE SPECIFIED:	APPLICATION SPEC 114-2046
0 PLC ± -	SIZE A2
1 PLC ± -	CAGE CODE 00779
2 PLC ± 0.25 [.010]	DRAWING NO C=62935
3 PLC ± -	RESTRICTED TO
4 PLC ± -	SCALE 10:1
ANGLES ± -	SHEET 1 OF 1
MATERIAL 4M BRASS	FINISH SEE TABLE
WEIGHT -	REV AH2
CUSTOMER DRAWING	