



WIRE-TO-BOARD CONNECTOR CONTACTS



TE CONNECTIVITY (TE)

REC 250 POSLOK 18-14 0157TPBR

Positive Lock | 250

63812-1

TE Internal Number: 63812-1

Always EU RoHS/ELV Compliant

Contact Type **Socket**

Wire/Cable Size (AWG) **18 - 14**

Wire/Cable Size (mm²) **.8 - 2**

Contact Mating Area Plating Material **Tin**

Packaging Method **Strip**

Active

PRODUCT DRAWING
English

3D PDF

Product Drawings

[RECEPTACLE, POSITIVE-LOCK, MK I, 6.35 \[.250\] SERIES](#)

PDF
English

CAD Files

[Customer View Model](#)

3D_STP.ZIP
English

[Customer View Model](#)

2D_DXF.ZIP
English

[3D PDF](#)

PDF
3D

[Customer View Model](#)

3D_IGS.ZIP
English

Catalog Pages/Data Sheets

[Positive Lock Receptacles](#)

PDF
English

Product Specifications

Application Specification

[Series 110 MK II, 187 MK II And MK III, Series 250 MK II, MK III, And RAST 5 & 7 Positive Lock Receptacle Connectors](#)

PDF
English

Product Environmental Compliance

TE Material Declaration

[MD_63812-1_06092014755_dmtec](#)

PDF
English

Please review product documents or [contact us](#) for the latest agency approval information. Please Note: Use the Product Drawing for all design activity.

Product Type Features	Product Type	Contact
	With Insulation Support	Yes
	Applies To	Wire/Cable
	Receptacle Style	Straight
Body Features	Material	Brass
Contact Features	Contact Type	Socket
	Contact Mating Area Plating Material	Tin
	Contact Mating Area Plating Thickness (µin)	40
	Contact Base Material	Brass
	Contact Plating Material	Tin
Termination Features	Termination Method to Wire/Cable	Crimp
	Crimp Area Plating Thickness (µin)	40
	Crimp Area Plating Material	Tin
Mechanical Attachment	Mating Area Interface Dimensions	.25 x .032 in, 6.35 x .81 mm
Dimensions	Wire/Cable Size (AWG)	18 – 14
	Wire/Cable Size (mm ²)	.8 – 2
	Insulation Diameter	3.43 – 4.95 mm [.135 – .195 in]
	Stock Thickness	.016 in, .41 mm
Packaging Features	Packaging Method	Strip
	Packaging Quantity	1500
Other	Comment	Only use with Type A Housings P/N 154719, or 154719-1. This receptacle has a smaller release latch and is designed for those Low Profile Housings
Product Compliance	Statement of Compliance PDF VIEW ALL PRODUCT COMPLIANCE	

CUSTOMERS ALSO BOUGHT

AUTOMOTIVE, TRUCK, BUS, & OFF-ROAD TERMINALS



FUSE CONTACT
880399-2



Save to List



Find Similar Products

AUTOMOTIVE, TRUCK, BUS, & OFF-ROAD HOUSINGS

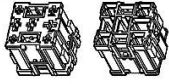

HSG ASS'Y 9 POS JR
444017-1



Save to List



Find Similar Products

MOTOR TERMINAL HOUSINGS



FASTON 250 REC HSG
1CIR NYLON NAT
521053-1



Save to List



Find Similar Products

POWER CONTACTS

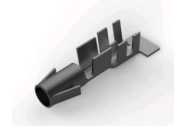

.140 DIA SOK 14-10 PTPBR
350200-1



Save to List



Find Similar Products

