

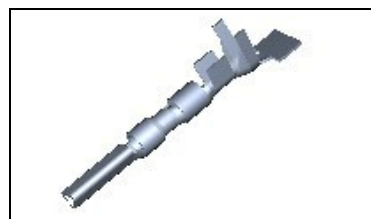

## 794221-1 Product Details

[Share](#) [Print](#) [Email](#)

**794221-1**

### .163" Centerline, 600 V, 9.5 A max.

Always EU RoHS/ELV Compliant (Statement of Compliance)

**Product Highlights:**

- Mini-Universal MATE-N-LOK 2 Product Line
- Wire-to-Wire
- Applies To Wire/Cable
- Contact
- Glow Wire Rating = Standard Part - Not Glow Wire

[View all Features](#)
**Quick Links**

- ▶ [Pricing & Availability](#)
- ▶ [Search for Tooling](#)
- ▶ [View Housings \(50\)](#)
- ▶ [Product Feature Selector](#)
- ▶ [Contact Us About This Product](#)

TE Internal Number: 794221-1

**Active**
[Add to My Part List](#) [Request Sample](#) [Find Similar Products](#) [Buy Product](#)

### Documentation & Additional Information

Documents are temporarily unavailable. We are working hard to correct the problem. Please try again later.

**Additional Information:**

- [Product Line Information](#)

**Related Products:**

- [Tooling](#)
- [Housings \(50\)](#)

### Product Features (Please use the Product Drawing for all design activity)

**Product Type Features:**

- Product Line = Mini-Universal MATE-N-LOK 2
- Product Type = Contact
- PCB Mount Retention = Without
- Sealed = No
- Wire/Cable Type = Discrete Wire

**Mechanical Attachment:**

- Contact Retention = Without
- Panel Mount Retention = Without

**Electrical Characteristics:**

- Contact - Rated Current (A) = 10.5
- Operating Voltage Reference = AC/DC
- Operating Voltage (VAC) = 600
- Operating Voltage (VDC) = 600

**Termination Features:**

- Wire/Cable Size (mm<sup>2</sup>) = 0.3 - 0.9
- Wire/Cable Size (AWG) = 18 - 22
- Termination Method to Wire/Cable = Crimp

**Body Features:**

- Used With = Plug Housing
- Mating Retention = Without
- Wire Type = Stranded
- Assembly Integration Feature = Without

**Contact Features:**

- Contact Type = Socket
- Contact Base Material = Brass
- Contact Plating, Mating Area, Material = Pre-Tin
- Shunts/Shorting Bars = Without
- Multiple Contact Types = Without

**Housing Features:**

- Mating Alignment = Without

**Configuration Features:**

- Strain Relief = Without

**Industry Standards:**

- [RoHS/ELV Compliance](#) = RoHS compliant, ELV compliant
- [Lead Free Solder Processes](#) = Not relevant for lead free process
- RoHS/ELV Compliance History = Always was RoHS compliant
- VDE Tested = Yes
- Agency/Standard = UL, CSA
- UL Rating = Recognized
- UL File Number = E28476

**Environmental:**

- Operating Temperature (°C [°F]) = -20 - +85 [-4 - +185]

**Conditions for Usage:**

- Applies To = Wire/Cable
- Glow Wire Rating = Standard Part - Not Glow Wire
- Accepts Wire Insulation Diameter, Range (mm [in]) = 1.50 - 2.39 [0.059 - 0.094]

**Operation/Application:**

- Application Use = Wire-to-Wire

**Packaging Features:**

- Packaging Method = Reel
- Packaging Quantity = 4,500

**Other:**

- Brand = AMP
- Comment = These contacts can be used in either Mini-Universal MATE-N-LOK 2 Plug or Cap housings ONLY.; HDM Applicator part number ending in -1 is used on AMPOMATOR CLS Machine with T or G Terminators, -2 is used on AMP-O-LECTRIC Model K Machine, -3 is used on AMP-O-LECTRIC Model G Machine.

[Feedback](#)

[Investors](#)

[News Room](#)

[Supplier Portal](#)

[Careers](#)

[Terms & Conditions](#)

[Privacy Policy](#)

[AODA Accessibility Policy](#)

[AODA Multi-Year Accessibility](#)

[Plan](#)

[Product Cross Reference](#)

[Documents & Drawings](#)

[Product Compliance Support Center](#)

[Site Map](#)

[Find a Phone Number](#)

[Knowledge Base](#)

[Manage Your Account](#)

