

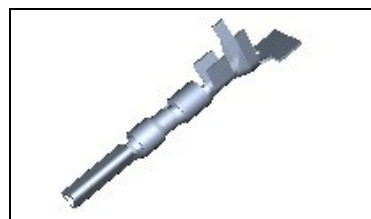

794221-3 Product Details



794221-3

.163" Centerline, 600 V, 9.5 A max.

Not EU RoHS or ELV Compliant ([Find RoHS Compliant Alternates](#))

Product Highlights:

- Mini-Universal MATE-N-LOK 2 Product Line
- Wire-to-Wire
- Applies To Wire/Cable
- Contact
- Glow Wire Rating = Standard Part - Not Glow Wire

[View all Features](#)

Quick Links

- ▶ [Pricing & Availability](#)
- ▶ [Search for Tooling](#)
- ▶ [View Housings \(50\)](#)
- ▶ [Product Feature Selector](#)
- ▶ [Contact Us About This Product](#)

TE Internal Number: 794221-3

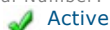

[Add to My Part List](#) |
 [Request Sample](#) |
 [Find Similar Products](#) |
 [Buy Product](#)

Documentation & Additional Information	
Documents are temporarily unavailable. We are working hard to correct the problem. Please try again later.	Additional Information: <ul style="list-style-type: none"> • Product Line Information Related Products: <ul style="list-style-type: none"> • Tooling • Housings (50)

Product Features (Please use the Product Drawing for all design activity)	
Product Type Features: <ul style="list-style-type: none"> • Product Line = Mini-Universal MATE-N-LOK 2 • Product Type = Contact • PCB Mount Retention = Without • Sealed = No • Wire/Cable Type = Discrete Wire Mechanical Attachment: <ul style="list-style-type: none"> • Contact Retention = Without • Panel Mount Retention = Without Electrical Characteristics: <ul style="list-style-type: none"> • Contact - Rated Current (A) = 10.5 • Operating Voltage Reference = AC/DC • Operating Voltage (VAC) = 600 • Operating Voltage (VDC) = 600 Termination Features: <ul style="list-style-type: none"> • Wire/Cable Size (mm²) = 0.3 - 0.9 • Wire/Cable Size (AWG) = 18 - 22 • Termination Method to Wire/Cable = Crimp Body Features: <ul style="list-style-type: none"> • Used With = Plug Housing • Mating Retention = Without • Wire Type = Stranded • Assembly Integration Feature = Without Contact Features: <ul style="list-style-type: none"> • Contact Type = Socket • Contact Base Material = Brass • Contact Plating, Mating Area, Material = Gold • Contact Plating, Mating Area, Thickness (µm [µin]) = 0.76 [29.92] • Shunts/Shorting Bars = Without • Multiple Contact Types = Without • Underplate Material = Nickel • Underplate Material Thickness (µm [µin]) = 1.27 [50.000] 	Housing Features: <ul style="list-style-type: none"> • Mating Alignment = Without Configuration Features: <ul style="list-style-type: none"> • Strain Relief = Without Industry Standards: <ul style="list-style-type: none"> • RoHS/ELV Compliance = Not ELV/RoHS compliant • Lead Free Solder Processes = Not relevant for lead free process • VDE Tested = Yes • Agency/Standard = CSA, UL • UL Rating = Recognized • UL File Number = E28476 Environmental: <ul style="list-style-type: none"> • Operating Temperature (°C [°F]) = -20 - +105 [-4 - +221] Conditions for Usage: <ul style="list-style-type: none"> • Applies To = Wire/Cable • Glow Wire Rating = Standard Part - Not Glow Wire • Accepts Wire Insulation Diameter, Range (mm [in]) = 1.50 - 2.39 [0.059 - 0.094] Operation/Application: <ul style="list-style-type: none"> • Application Use = Wire-to-Wire Packaging Features: <ul style="list-style-type: none"> • Packaging Method = Reel • Packaging Quantity = 4,500 Other: <ul style="list-style-type: none"> • Brand = AMP • Comment = HDM Applicator part number ending in -1 is used on AMPOMATOR CLS Machine with T or G Terminators, -2 is used on AMP-O-LECTRIC Model K Machine, -3 is used on AMP-O-LECTRIC Model G Machine.; These contacts can be used in either Mini-Universal MATE-N-LOK 2 Plug or Cap housings ONLY.

Feedback

[News Room](#)

[Supplier Portal](#)

[Careers](#)

[Terms & Conditions](#)

[Privacy Policy](#)

[AODA Accessibility Policy](#)

[AODA Multi-Year Accessibility
Plan](#)

[Documents & Drawings](#)

[Product Compliance Support Center](#)

[Site Map](#)

[Knowledge Base](#)

[Manage Your Account](#)

