



Have a Question?
Chat with a Product Information Specialist

What can we help you find?

- [Products](#)
- [Industries](#)
- [Resources](#)
- [About TE](#)
- [My Account](#)
- [Innovation](#)
- [Support Center](#)

917485-2 Product Details

- [Share](#)
- [Print](#)
- [Email](#)

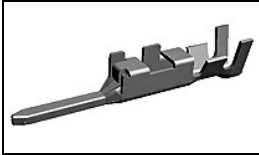

917485-2

TE Internal Number: 917485-2
✔ Active

[View 3D PDF](#)

Dynamic Series Connectors

✔ Always EU RoHS/ELV Compliant (Statement of Compliance)

Product Highlights:

- Applies To Wire/Cable
- Contact
- Contact Type = Pin
- Product Series = D-3
- Wire Range = 1.25-2.00² [16-14] mm [AWG]

[View all Features](#)

Quick Links

- [▶ Pricing & Availability](#)
- [▶ Search for Tooling](#)
- [▶ View Housings \(60\)](#)
- [▶ Product Feature Selector](#)
- [▶ Contact Us About This Product](#)

- [Add to My Part List](#)
 - [Request Sample](#)
 - [Find Similar Products](#)
- [Buy Product](#)

Documentation & Additional Information	
<p>Product Drawings:</p> <ul style="list-style-type: none"> "2L" SIZE (DYNAMIC D-3 SERIES TAB. CONTACT) (PDF, English) <p>Catalog Pages/Data Sheets:</p> <ul style="list-style-type: none"> HTS Heavy Duty Connectors catalogue (PDF, English) <p>Product Specifications:</p> <ul style="list-style-type: none"> Dynamic Connector D-3000 Series (PDF, Japanese) Dynamic D-3800 Series With HTS Connector (PDF, Japanese) DYNAMIC D-2600 SERIES HYBRID 48P CONN (PDF, Japanese) <p>Application Specifications:</p> <ul style="list-style-type: none"> DYNAMIC Series D-3, Crimp-in Type Contacts (PDF, Japanese) <p>Instruction Sheets:</p> <ul style="list-style-type: none"> EXTRACTION TOOL FOR DYNAMIC D-3000 SERIES (PDF, English) MULTIPLE ENCLOSURE 67M D1200 15POS. TAB PLUG (PDF, Japanese) <p>CAD Files: (CAD Format & Compression Information)</p> <ul style="list-style-type: none"> 2D Drawing (DXF, Version A) 3D Model (IGES, Version A) 3D Model (STEP, Version A) 	<p>Additional Information:</p> <ul style="list-style-type: none"> Product Line Information <p>Related Products:</p> <ul style="list-style-type: none"> Tooling Housings (60)

[List all Documents](#)

Product Features (Please use the Product Drawing for all design activity)	
<p>Product Type Features:</p> <ul style="list-style-type: none"> Product Type = Contact Product Series = D-3 Insertion Force = Standard <p>Termination Features:</p> <ul style="list-style-type: none"> Termination End Plating = Gold over Nickel <p>Dimensions:</p> <ul style="list-style-type: none"> Insulation Diameter (mm [in]) = 2.20-2.80 [.086-.110] <p>Body Features:</p> <ul style="list-style-type: none"> Wire Range (mm [AWG]) = 1.25-2.00² [16-14] <p>Contact Features:</p> <ul style="list-style-type: none"> Contact Type = Pin Contact Plating, Mating Area, Material = Gold (15) Contact Base Material = Copper Alloy 	<p>Industry Standards:</p> <ul style="list-style-type: none"> RoHS/ELV Compliance = RoHS compliant, ELV compliant Lead Free Solder Processes = Not relevant for lead free process RoHS/ELV Compliance History = Always was RoHS compliant <p>Identification Marking:</p> <ul style="list-style-type: none"> Wire Range Mark = 2L <p>Conditions for Usage:</p> <ul style="list-style-type: none"> Applies To = Wire/Cable <p>Packaging Features:</p> <ul style="list-style-type: none"> Packaging Quantity = 3,000 Packaging Method = Reel <p>Other:</p> <ul style="list-style-type: none"> Brand = AMP

Corporate Information

[About TE](#)

Quick Links

[Distributor Inventory](#)

Customer Support

[Email or Chat With Us](#)

- [Investors](#)
- [News Room](#)
- [Supplier Portal](#)
- [Careers](#)
- [Terms & Conditions](#)
- [Privacy Policy](#)

- [Product Cross Reference](#)
- [Documents & Drawings](#)
- [Product Compliance Support Center](#)
- [Site Map](#)

- [Find a Phone Number](#)
- [Knowledge Base](#)
- [Manage Your Account](#)

Keep Me Informed

Receive TE News, Events & Technology Updates

Enter your email address

