

[My Cart](#) | [My Part Lists](#) | [Sign In/Register](#)[English \(Change\)](#)**Have a Question?**Chat with a Product
Information Specialist

What can we help you find?

[Products](#)[Industries](#)[Resources](#)[About TE](#)[My Account](#)[Innovation](#)[Support Center](#)**926498-3 Product Details**[Share](#)[Print](#)[Email](#)**926498-3**

TE Internal Number: 926498-3

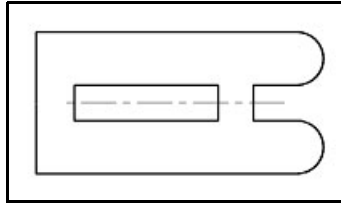

Active

[View 3D PDF](#)**.100 inch AMPMODU Receptacles**Always EU RoHS/ELV Compliant (Statement of
Compliance)**Product Highlights:**

- Accessory
- Accessory Type = Keying Plug
- Mod II
- RoHS compliant, ELV compliant
- Lead Free Solder Processes = Not relevant for lead free process

[View all Features](#)**Quick Links**

- ▶ [Check Pricing & Availability](#)
- ▶ [Search for Tooling](#)
- ▶ [Product Feature Selector](#)
- ▶ [Contact Us About This Product](#)

[Add to My Part List](#)[Request Sample](#)[Find Similar Products](#)[Buy Product](#)**Documentation & Additional Information****Product Drawings:**

- [VERSCHLUESSELUNGSTEIL](#) (PDF, English)

Catalog Pages/Data Sheets:

- None Available

Product Specifications:

- [AMPMODU MOD II Interconnection System](#) (PDF, English)

Application Specifications:

- None Available

Instruction Sheets:

- None Available

CAD Files: ([CAD Format & Compression Information](#))

- [2D Drawing](#) (DXF, Version 1)

Additional Information:

- [Product Line Information](#)

Related Products:

- [Tooling](#)

- [3D Model](#) (IGES, Version 1)
- [3D Model](#) (STEP, Version 1)

[List all Documents](#)**Product Features (Please use the Product Drawing for all design activity)****Product Type Features:**

- [Product Type](#) = Accessory
- [Accessory Type](#) = Keying Plug
- [Connector Series](#) = Mod II

Body Features:

- Keying Plug Color = Red
- Material = Polyamide 6.6

Industry Standards:

- Government/Industry Qualification = No
- [RoHS/ELV Compliance](#) = RoHS compliant, ELV compliant
- [Lead Free Solder Processes](#) = Not relevant for lead free process
- RoHS/ELV Compliance History = Always was RoHS compliant

Conditions for Usage:

- For Use With = AMPMODU IV

Other:

- Brand = AMP

Corporate Information

[About TE](#)
[Investors](#)
[News Room](#)
[Supplier Portal](#)
[Careers](#)
[Terms & Conditions](#)
[Privacy Policy](#)

Quick Links

[Check Distributor Inventory](#)
[Cross Reference Products](#)
[Find Documents & Drawings](#)
[Product Compliance Support Center](#)
[Site Map](#)

Customer Support

[Email or Chat With Us](#)
[Find a Phone Number](#)
[Search Knowledge Base](#)
[Manage Your Account](#)

Keep Me Informed

Receive TE News, Events & Technology Updates

Enter your email address



