

## Vitreous Resistors with Corrugated Ribbon



### FEATURES

- All welded construction
- High power rating up to 1000 W
- Corrugated ribbon construction aids rapid cooling
- Complete vitreous coating for perfect humidity protection
- Adjustable design available = “E”
- Compliant to RoHS directive 2002/95/EC



**RoHS**  
COMPLIANT  
**GREEN**  
(5-2009)\*\*

### STANDARD ELECTRICAL SPECIFICATIONS

MODEL	POWER RATING $P_{40\text{ }^\circ\text{C}}$		RESISTANCE RANGE (1)			TOLERANCE
	WM 50 WM 110	WM 10	TCR + 650 ... + 750 ppm/K WM 10	TCR - 10 ... - 80 ppm/K WM 50	TCR + 100 ... + 180 ppm/K WM 110	
GBS 20/100 GBS 20/100 E	80 W 50 W	50 W	0.13 $\Omega$ to 0.51 $\Omega$	0.56 $\Omega$ to 2.2 $\Omega$	1.3 $\Omega$ to 6.2 $\Omega$	$\pm 10\%$ , $\pm 5\%$
GBS 20/165 GBS 20/165 E	160 W 100 W	100 W	0.27 $\Omega$ to 1.0 $\Omega$	1.1 $\Omega$ to 4.7 $\Omega$	2.4 $\Omega$ to 12 $\Omega$	$\pm 10\%$ , $\pm 5\%$
GBS 20/265 GBS 20/265 E	300 W 180 W	180 W	0.47 $\Omega$ to 1.8 $\Omega$	2.0 $\Omega$ to 7.5 $\Omega$	4.3 $\Omega$ to 22 $\Omega$	$\pm 10\%$ , $\pm 5\%$
GBS 30/100 GBS 30/100 E	150 W 90 W	90 W	0.10 $\Omega$ to 0.43 $\Omega$	0.47 $\Omega$ to 3.3 $\Omega$	1.0 $\Omega$ to 8.2 $\Omega$	$\pm 10\%$ , $\pm 5\%$
GBS 30/133 GBS 30/133 E	200 W 120 W	120 W	0.15 $\Omega$ to 0.62 $\Omega$	0.68 $\Omega$ to 5.1 $\Omega$	1.5 $\Omega$ to 12 $\Omega$	$\pm 10\%$ , $\pm 5\%$
GBS 30/165 GBS 30/165 E	250 W 150 W	150 W	0.20 $\Omega$ to 0.91 $\Omega$	1.0 $\Omega$ to 6.8 $\Omega$	2.0 $\Omega$ to 16 $\Omega$	$\pm 10\%$ , $\pm 5\%$
GBS 30/215 GBS 30/215 E	300 W 200 W	200 W	0.27 $\Omega$ to 1.1 $\Omega$	1.2 $\Omega$ to 9.1 $\Omega$	2.7 $\Omega$ to 24 $\Omega$	$\pm 10\%$ , $\pm 5\%$
GBS 30/265 GBS 30/265 E	375 W 250 W	250 W	0.30 $\Omega$ to 1.3 $\Omega$	1.5 $\Omega$ to 11 $\Omega$	3.9 $\Omega$ to 27 $\Omega$	$\pm 10\%$ , $\pm 5\%$
GBS 30/330 GBS 30/330 E	450 W 350 W	350 W	0.39 $\Omega$ to 1.8 $\Omega$	2.0 $\Omega$ to 15 $\Omega$	5.1 $\Omega$ to 36 $\Omega$	$\pm 10\%$ , $\pm 5\%$
GBS 45/370 GBS 45/370 E	750 W 550 W	550 W	0.75 $\Omega$ to 3.0 $\Omega$	3.3 $\Omega$ to 24 $\Omega$	8.2 $\Omega$ to 56 $\Omega$	$\pm 10\%$ , $\pm 5\%$
GBS 60/370 GBS 60/370 E	1000 W 700 W	700 W	0.91 $\Omega$ to 3.9 $\Omega$	4.3 $\Omega$ to 33 $\Omega$	10 $\Omega$ to 75 $\Omega$	$\pm 10\%$ , $\pm 5\%$

### Notes

(1) Resistance value to be selected for  $\pm 10\%$  tolerance from E12 and for  $\pm 5\%$  from E24

- For available “Mounting Accessories for Resistors”, please see: [www.vishay.com/ppg?21015](http://www.vishay.com/ppg?21015)

\*\* Please see document “Vishay Material Category Policy”: [www.vishay.com/doc?99902](http://www.vishay.com/doc?99902)

PART NUMBER AND PRODUCT DESCRIPTION						
Part Number: GBS60AA03750KLX000						
<div style="display: flex; justify-content: space-around; text-align: center;"> <span>G</span><span>B</span><span>S</span><span>6</span><span>0</span><span>A</span><span>A</span><span>0</span><span>3</span><span>7</span><span>5</span><span>0</span><span>K</span><span>L</span><span>X</span><span>0</span><span>0</span><span>0</span> </div>						
MODEL	VARIANT/ TERMINAL	TCR/MATERIAL	VALUE	TOLERANCE CODE	PACKAGING CODE	SPECIAL
<b>GBS202S</b> = GBS 20/100 <b>GBS204L</b> = GBS 20/165 <b>GBS207D</b> = GBS 20/265 <b>GBS302S</b> = GBS 30/100 <b>GBS303P</b> = GBS 30/133 <b>GBS304L</b> = GBS 30/165 <b>GBS305Z</b> = GBS 30/215 <b>GBS307D</b> = GBS 30/265 <b>GBS3096</b> = GBS 30/330 <b>GBS45AA</b> = GBS 45/370 <b>GBS60AA</b> = GBS 60/370	<b>0</b> = Neutral <b>1</b> = E <b>Z</b> = Value overflow (BV)	<b>1</b> = - 10 ... - 80 ppm/K WM 50 Class 1 <b>3</b> = 100 ... 180 ppm/K WM 110 Class 3 <b>4</b> = 650 ... 750 ppm/K WM 10 <b>5</b> = SWI	<b>2 digit value</b> <b>1 digit multiplier</b> <b>MULTIPLIER</b> <b>8</b> = *10 <sup>-2</sup> <b>9</b> = *10 <sup>-1</sup> <b>0</b> = *10 <sup>0</sup>	<b>J</b> = ± 5.0 % <b>K</b> = ± 10.0 %	<b>LX</b> = Loose pack, without quantity <b>ZX</b> = Special pack (with BV #), without quantity	The 5 digit BV number will be encoded using a 36 character code. This code contains numbers 0...9 and letters A...Z (36 characters total) and allows to encode at least 46 655 five digit BV numbers. <b>000</b> = Standard
Product Description: GBS60/370 110 75R 10 % LX						
GBS60/370	110	75R	10 %	LX		
MODEL (1)	TCR/MATERIAL (1)	VALUE (1)	TOLERANCE CODE (1)	PACKAGING DESCRIPTION (2)		

**Notes**

- (1) See "Part Number" above
- (2) See "Packaging Code" above

**DIMENSIONS**

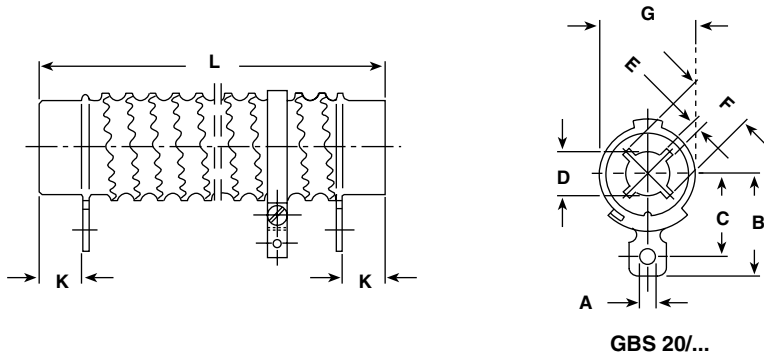

MODEL	DIMENSIONS in millimeters [inches]									
	L	K	A	B	C	D	E	F	G	MASS (g)
<b>GBS 20/100</b> <b>GBS 20/100 E</b>	100 ± 2.5 [3.937 ± 0.098]	15 [0.591]	4.2 [0.165]	26.5 [1.043]	22 [0.866]	10 [0.394]	1.5 [0.059]	14 [0.551]	24 [0.945]	100
<b>GBS 20/165</b> <b>GBS 20/165 E</b>	165 ± 4 [6.496 ± 0.157]	15 [0.591]	4.2 [0.165]	26.5 [1.043]	22 [0.866]	10 [0.394]	1.5 [0.059]	14 [0.551]	24 [0.945]	150
<b>GBS 20/265</b> <b>GBS 20/265 E</b>	265 ± 6.6 [10.433 ± 0.260]	15 [0.591]	4.2 [0.165]	26.5 [1.043]	22 [0.866]	10 [0.394]	1.5 [0.059]	14 [0.551]	24 [0.945]	250

**DIMENSIONS** (continued)

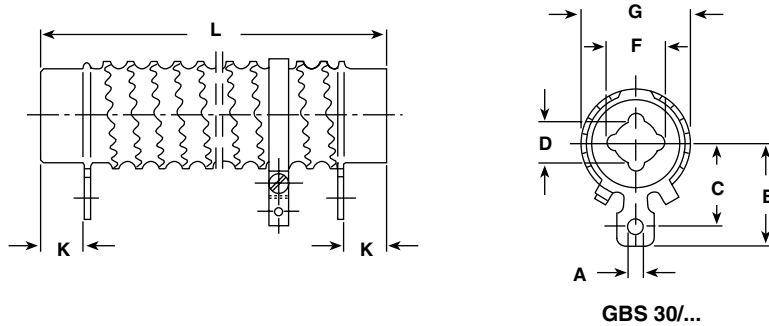

MODEL	DIMENSIONS in millimeters [inches]								
	L	K	A	B	C	D	F	G	MASS (g)
GBS 30/100 GBS 30/100 E	100 ± 2.5 [3.937 ± 0.098]	15 [0.591]	5.2 [0.205]	34 [1.339]	28 [1.102]	14 [0.551]	18.5 [0.728]	37 ± 1 [1.457 ± 0.039]	200
GBS 30/133 GBS 30/133 E	133 ± 3.3 [5.236 ± 0.130]	15 [0.591]	5.2 [0.205]	34 [1.339]	28 [1.102]	14 [0.551]	18.5 [0.728]	37 ± 1 [1.457 ± 0.039]	250
GBS 30/165 GBS 30/165 E	165 ± 4 [6.496 ± 0.157]	15 [0.591]	5.2 [0.205]	34 [1.339]	28 [1.102]	14 [0.551]	18.5 [0.728]	37 ± 1 [1.457 ± 0.039]	300
GBS 30/215 GBS 30/215 E	215 ± 5.4 [8.465 ± 0.213]	15 [0.591]	5.2 [0.205]	34 [1.339]	28 [1.102]	14 [0.551]	18.5 [0.728]	37 ± 1 [1.457 ± 0.039]	400
GBS 30/265 GBS 30/265 E	265 ± 6.6 [10.433 ± 0.260]	15 [0.591]	5.2 [0.205]	34 [1.339]	28 [1.102]	14 [0.551]	18.5 [0.728]	37 ± 1 [1.457 ± 0.039]	500
GBS 30/330 GBS 30/330 E	330 ± 8 [12.992 ± 0.315]	15 [0.591]	5.2 [0.205]	34 [1.339]	28 [1.102]	14 [0.551]	18.5 [0.728]	37 ± 1 [1.457 ± 0.039]	600

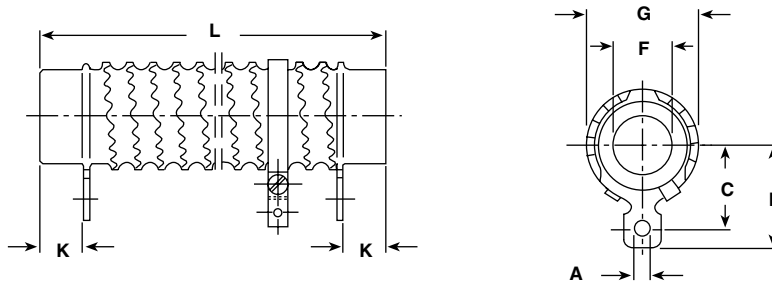

MODEL	DIMENSIONS in millimeters [inches]							
	L	K	A	B	C	F	G	MASS (g)
GBS 45/370 GBS 45/370 E	370 ± 9 [14.567 ± 0.354]	15 [0.591]	5.2 [0.205]	42.5 [1.673]	37 [1.457]	30 [1.181]	52 ± 1 [2.047 ± 0.039]	1000
GBS 60/370 GBS 60/370 E	370 ± 9 [14.567 ± 0.354]	15 [0.591]	5.2 [0.205]	51.5 [2.028]	45.5 [1.791]	45 [1.772]	67 ± 1 [2.638 ± 0.039]	1200

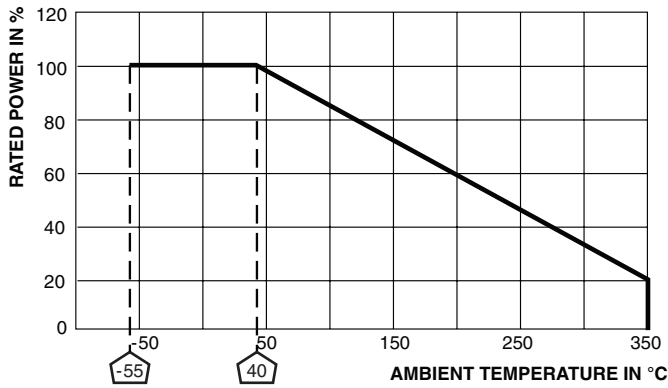

**Derating**

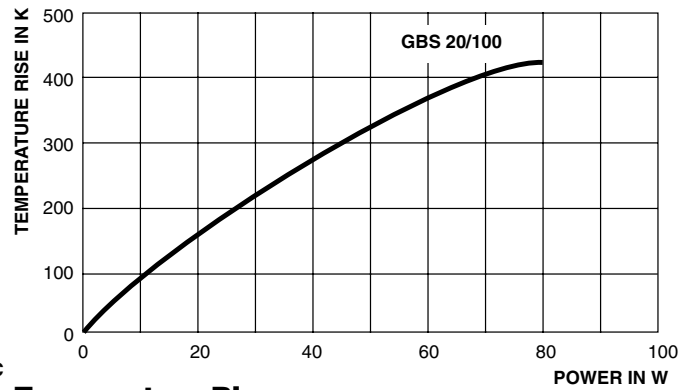

**Temperature Rise**

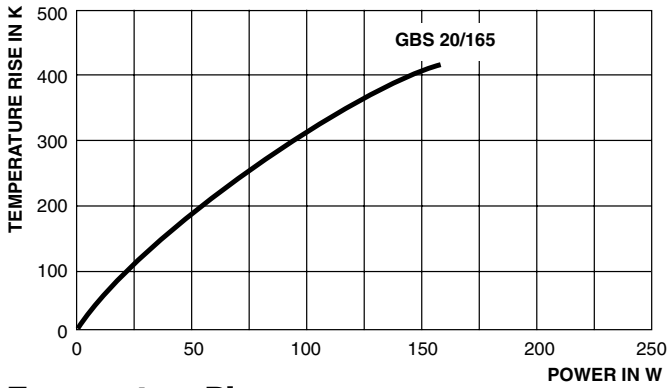

**Temperature Rise**

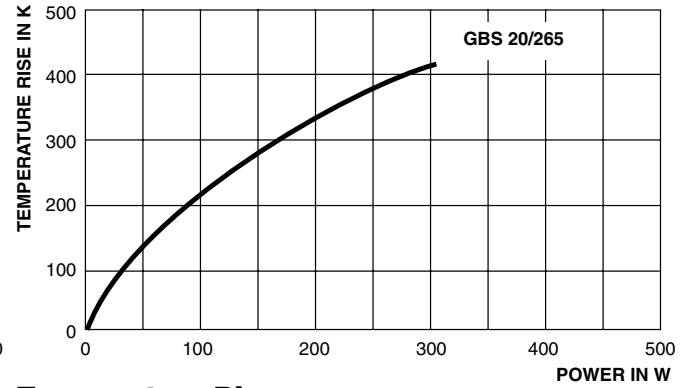

**Temperature Rise**

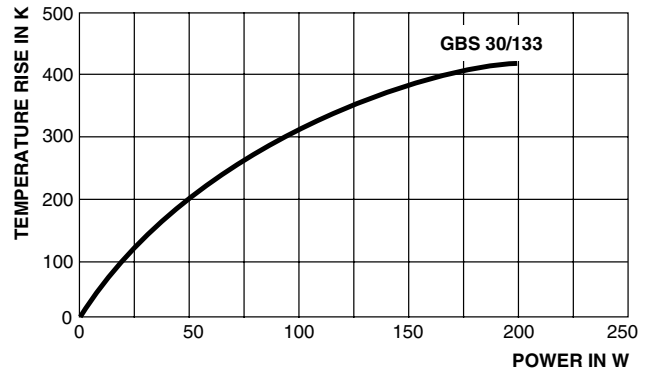
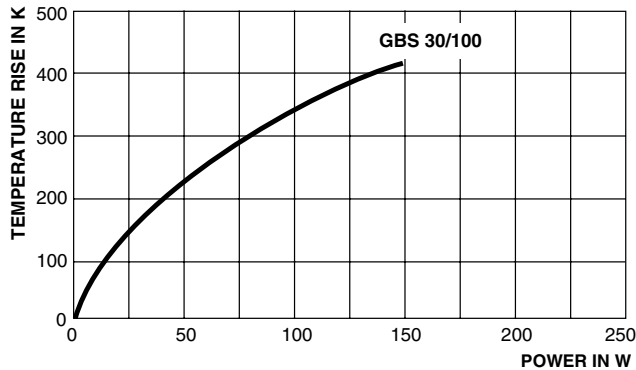

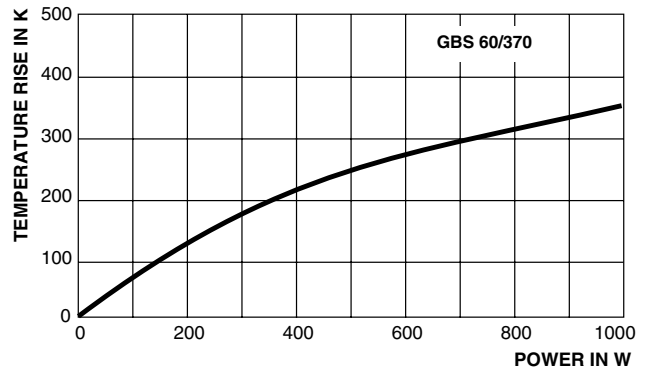
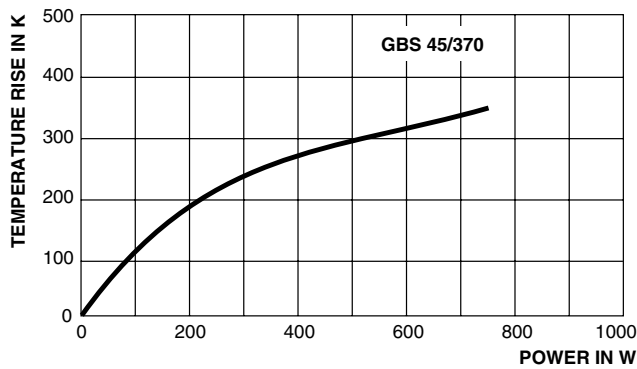
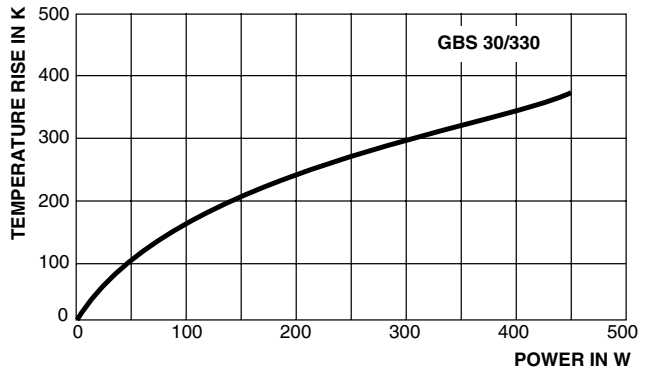
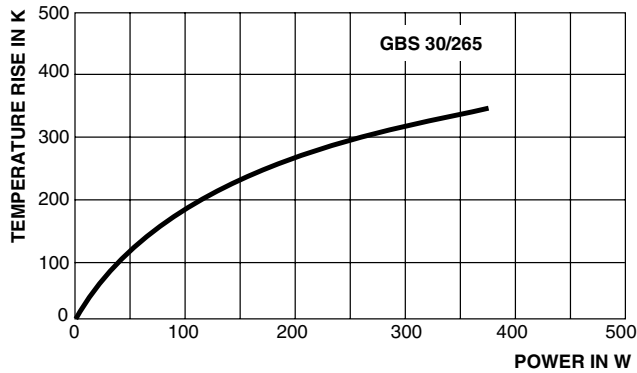
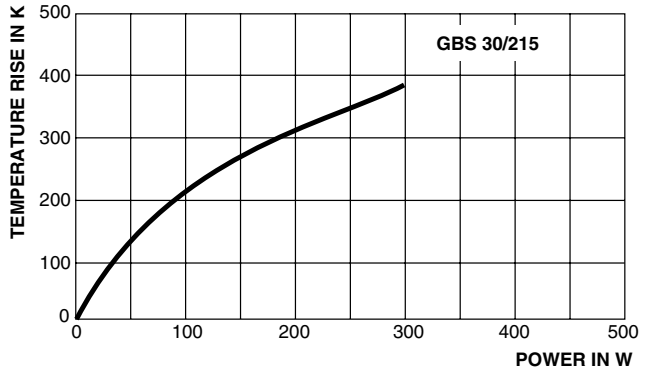
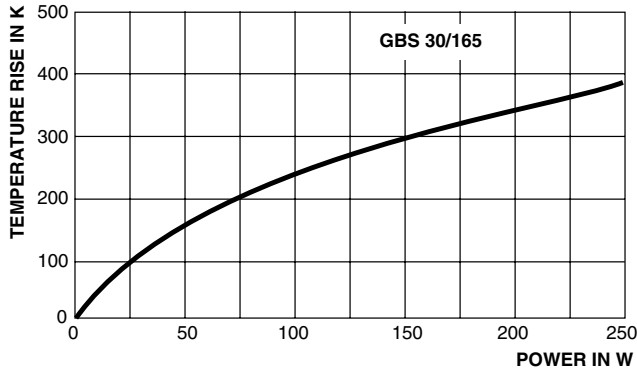



## Disclaimer

All product specifications and data are subject to change without notice.

Vishay Intertechnology, Inc., its affiliates, agents, and employees, and all persons acting on its or their behalf (collectively, "Vishay"), disclaim any and all liability for any errors, inaccuracies or incompleteness contained herein or in any other disclosure relating to any product.

Vishay disclaims any and all liability arising out of the use or application of any product described herein or of any information provided herein to the maximum extent permitted by law. The product specifications do not expand or otherwise modify Vishay's terms and conditions of purchase, including but not limited to the warranty expressed therein, which apply to these products.

No license, express or implied, by estoppel or otherwise, to any intellectual property rights is granted by this document or by any conduct of Vishay.

The products shown herein are not designed for use in medical, life-saving, or life-sustaining applications unless otherwise expressly indicated. Customers using or selling Vishay products not expressly indicated for use in such applications do so entirely at their own risk and agree to fully indemnify Vishay for any damages arising or resulting from such use or sale. Please contact authorized Vishay personnel to obtain written terms and conditions regarding products designed for such applications.

Product names and markings noted herein may be trademarks of their respective owners.